

Children's Health

EYP/HEALTH

WHR ARCHITECTS | STANLEY BEAMAN & SEARS

/ healthcare

Over the past seven years, the successful collaboration of EYP, WHR, and Stanley, Beaman & Sears has delivered innovative projects for clients. Now we are EYP Health, united in our purpose to help clients transform the future of healthcare. We offer clients the local teams they know and trust – now as part of high-performance design leader EYP, with professionals working across 15 offices around the United States and in Europe. Our collaborative approach provides exceptional project delivery and a seamless client experience.

EYP Health brings decades of experience integrating building technology, functional efficiency, and aesthetics for both public and private partners. We understand the fiscal and construction issues presented by complex, large-scale projects. We balance critical thinking with empathy to create inspiring, efficient, and cost-effective environments that promote health, inspire confidence, and enhance well-being for patients, staff, and visitors.

Disciplines

Architecture, Engineering, Energy, Environmental Graphic Design, Interior Design, Master Planning, Medical Planning

Expertise

- Academic Medical Centers
- Ambulatory & Outpatient Care
- Behavioral Health
- Cancer Care
- Cardiovascular Specialty Hospitals
- Critical Care
- Emergency & Trauma
- Community / Greenfield Hospitals
- Inpatient & Outpatient Surgery
- Inpatient Departments
- Orthopedic Care
- Children's Health
- Teaching Hospitals
- Women's Services

Research

EYP Health seeks out opportunities for research investigations to advance designs that optimize the patient, visitor, and staff experience while maximizing value for owners. As the leader in innovation through evidence-based design, we helped found – and continue to collaborate with – the Center for Health Design (CHD) and the CHD Pebble Project. Our thought leaders continually grow the body of information available to facility users and architects through publications and active participation in organizations including the International Academy for Design and Health, the Society of Critical Care Medicine, and the Robert Wood Johnson Foundation.

Recognition

#10 in Healthcare Design — *Giants 300, Building Design + Construction*

Contact

Charles Griffin, FAIA, FACHA, EDAC - Healthcare Sector Leader
713 852 3649 / cgriffin@eypae.com

Kimberly Stanley, AIA - Children's Health Specialist
404 524 2200 / kimberly@sbs-architecture.com

Jennifer Conrad, EDAC - Director of Business Development, Healthcare
214 276 6979 / jconrad@eypae.com

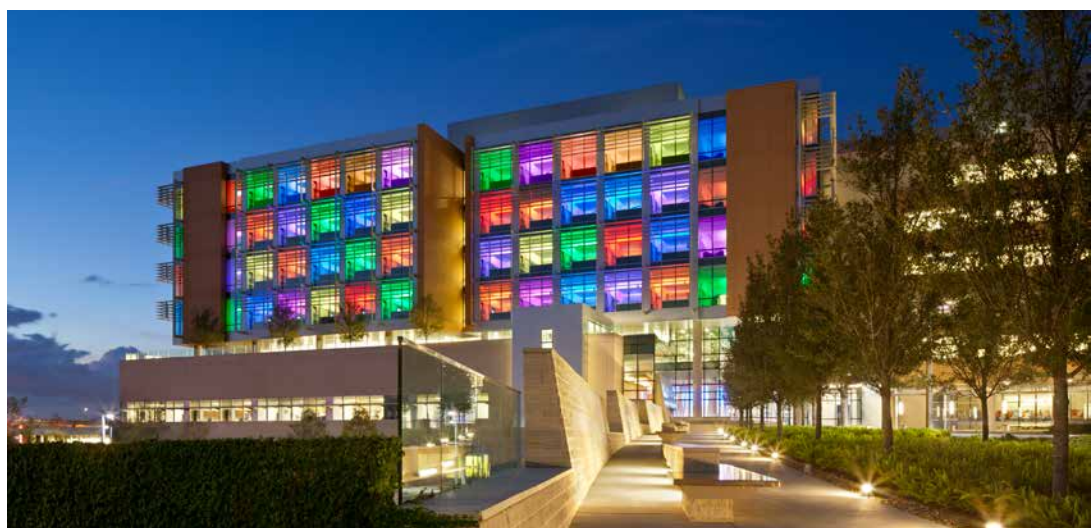

/ children's health

EYP Health is a leader in the design of leading-edge facilities for children that promote wellness, facilitate the delivery of care, and support family-centered medicine. We have a passion for working with clients whose operational and facility goals involve families as active participants in the healing process. Inspired by our clients' mission and informed by the research indicating a strong relationship between the built environment and clinical outcomes, our designs:

- respond to the scale of children
- welcome and accommodate families
- creatively respond to different age groups and diverse cultures
- promote visibility, security, and safety
- are flexible and adaptable for the future

We believe that integrating environmental graphic design helps reinforce the atmosphere of healing and enhances the patient and family experience. Over 20 years ago, we were the first to integrate technology for education and entertainment into children's hospitals. Colorful and dynamic, interactive environments enhance young patients' journey to health and wellness by allowing them a sense of control over their situation and a welcome distraction from treatment.

Promoting human health and well-being through design is how we help our clients realize their vision to improve healthcare delivery and patient outcomes.

“Mankind owes to the child the best it has to give.”

—*United Nations Convention on the Rights of the Child*

/ Nemours Healthcare Campus Orlando, FL
Children's Hospital



Pediatric healthcare delivery in Central Florida has been transformed by a new hospital that uniquely aligns outpatient and inpatient care, and features the area's only emergency department designed especially for children. The sleek, modern design showcases an exceptionally family-focused program with leading-edge technology, as well as research and education facilities.

Our collaborative design process actively involved parents and children, as well as medical staff and administrators. Because familiar faces and continuity of care are reassuring to patients and families, ambulatory and acute care spaces for medical specialties are housed in adjacent wings of the same floor with shared waiting spaces. Whether hospitalized or visiting a clinic, children see the same physicians and clinical staff.

Private patient rooms provide home-like overnight accommodations for parents. Elevator lobbies include amenities like laundry facilities and a concierge station. Lounges, playrooms, rooftop terraces, interactive water features, a discovery garden, and an outdoor stage contribute to a holistic healing environment. Sited in a 60-acre health and life sciences park, Nemours is one of only three LEED Gold-certified pediatric hospitals in Florida. Sustainable design features, including green roofs and sunshades, promote occupant health and comfort while providing energy savings of 22% beyond ASHRAE 90.1.

We were Design Architect and Architect of Record in collaboration with Perkins + Will.

- 630,000 GSF
- 95 beds and shellspace for 32 more
- 76 Exam Rooms and shellspace for 24 more
- NICU, PICU
- 17 design awards





/ University of Virginia Health System

Charlottesville, VA

The Battle Building at UVA Children's Hospital



Two distinct healthcare units – Outpatient Surgery and Outpatient Children’s Hospital Clinics – are united in this campus gateway building, the 21st-century descendant of Thomas Jefferson’s iconic rotunda. The design organizes 36 specialty clinics into interdisciplinary, multi-functional care neighborhoods.

Complementary clinics are conveniently collocated so that multiple caregivers can attend to patients in one place, rather than requiring patients to go from one clinic to another. To simplify wayfinding for children and families, floors are organized with environmental graphics that tell the story of UVA and Charlottesville. The child-focused facility uses static displays and interactive features to engage young patients with a storytelling theme that highlights classics of children’s literature including Charlotte’s Web, Curious George, and The Jungle Book.

The program features a “Main Street” of amenities; 40-foot-long interactive storytelling walls in each of the four upper-floor waiting rooms; and family activity areas.

Odell Associates were Architect of Record.

- LEED Gold certified
- 200,300 GSF
- 75 examination rooms
- 12 operating rooms
- 36 specialty clinics
- IIDA Best of the Best Awards - Healthcare Award of Merit Large Healthcare
- AIA Honor Award - Richmond, VA





/ University of Chicago Hospitals Chicago, IL
Comer Children's Hospital



Families and young patients who enter the Hospital find world-class healthcare in a compassionate, wholly child-centered environment. To fulfill the client's vision of continuously advancing pediatric care, the design relates to the needs and imagination of children, as well as to the requirements of pediatric medicine's rapidly advancing technologies.

The design fosters confidence in the promise of modern medicine while being open and welcoming. State-of-the-art equipment and facilities coexist with inviting spaces to play and learn, as well as home-like patient rooms that accommodate overnight family stays. Other family-friendly spaces include a kitchen, resource center, and outdoor playground.

The contemporary architecture reinterprets the Collegiate Gothic vernacular of the campus. The design combines glass curtain wall with pre-cast concrete columns and panels to create a complex and dynamic form of overlapping masses – soaring steel “buttresses” that complement neighboring structures. These bold forms are counterbalanced by fine details referencing the client's legacy of education and research. Subtle patterning in the pre-cast concrete panels recalls the large and elaborate typefaces characteristic of many children's books, or the ivy that adorns many buildings on campus. Two main stair towers anchor the structure like bookends on the north and south ends.

HLM Design (Proteus) was Architect of Record.

- 242,000 GSF
- 6 floors
- 155 beds
- Family amenities
- The Center for Health Design Annual Healthcare Environment Award
- American School & University Architecture Competition





/ St. Jude Children's Research Hospital

Memphis, TN

Kay Research and Care Center



Inventive and engaging, the modernized facility complements world-class pediatric care with magic and whimsy to create a holistic healing experience. Immersive experiential design sparks children's imagination, distracting them from the stress of their lengthy hospital stays by inspiring and supporting play.

The design reimagines the 50-foot-long corridors leading from elevators to treatment areas as interactive "Journey Walls" with LED curtains and immersive audiovisual systems. Each of the three floors guides children and their families through a unique experience – Nature's Orchestra, Discover the Sea, and Explore Space – whose theme is richly realized through environmental graphics, custom interactive games, and every aspect of the interior design.

Each of the three renovated floors houses a unit of 17 family suites with home-like rooms for parents as well as patients. To encourage children to get out of their rooms and socialize with others, patient corridors feature interactive shadow boxes and "Discovery Walls," whose nine flat-panel LCD displays are programmed for gestural interactive play.

The centrally located Imagine Room, whose interactive screen curves into the ceiling, allows children to enjoy virtual experiences such as soaring through space, flying above trees, or swimming with fish.

Evans Taylor Foster Childress was Architect of Record.

- IES (Illuminating Engineering Society of North America) Illumination Award
- IIDA Award for Healthcare Renovation - Tennessee Chapter
- IIDA Best of All Design - Tennessee Chapter
- IIDA Best of the Best Awards - Overall - Georgia Chapter
- IIDA Best of the Best Awards - Large Healthcare - Georgia Chapter





DISCOVER GOVERNMENT

Design Center



/ University Hospitals Rainbow Babies &
Children's Hospital Cleveland, OH

Angie Fowler Adolescent & Young Adult Cancer Center

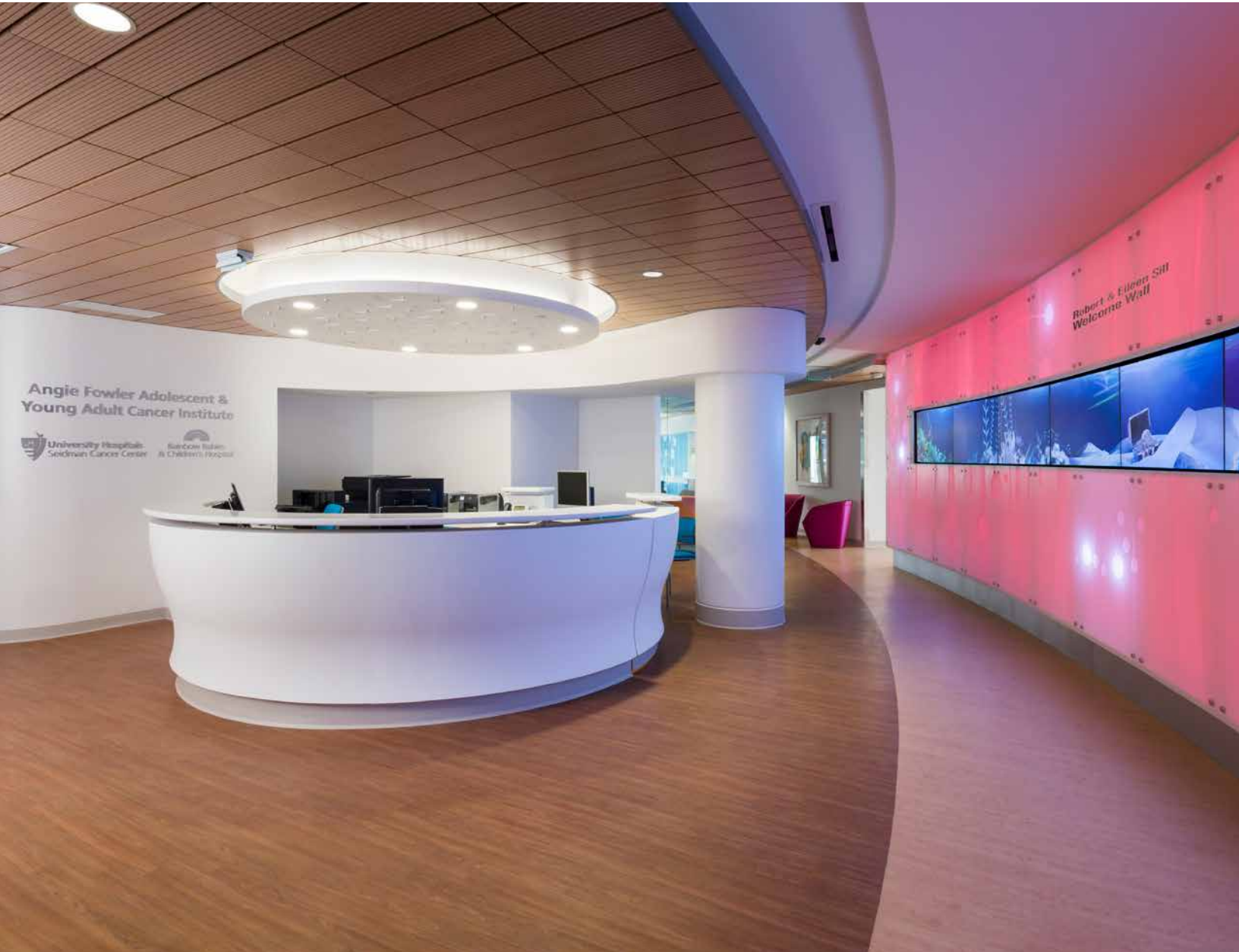

One of the nation's top-ranked children's hospitals now offers adolescent and young adult cancer patients an innovative outpatient experience that meets their distinctive treatment and social needs. Our team worked closely with medical staff, patients, families, and the Fowler family – the donor in whose daughter's memory the Institute was named – to create an innovative environment that has proven effective both in treating patients and in attracting top cancer researchers and physicians.



The design transforms the eighth floor of Rainbow Babies & Children's Hospital into a "journey of light and healing" through various zones of interaction. Patients follow the 60-foot-long illuminated "welcome wall" from the lobby to one of two treatment wings and a decentralized-care team station adjacent to treatment and examination rooms. Possible stops along the way include waiting areas, consultation and meeting rooms and a pharmacy, as well as a teen lounge where patients can hang out together or retreat on their own.



The rooftop Angie's Garden, with animal sculptures and landscaped seating areas, offers an imaginative escape from the clinical environment.

- 18,500 GSF modernization
- 7,500 GSF rooftop healing garden
- 25 Treatment & examination rooms
- Consultation & meeting spaces
- Teen lounge
- Pharmacy
- Healthcare Environment Award, *Contract Magazine* - Honorable Mention
- IIDA Best of the Best Awards - Small Healthcare



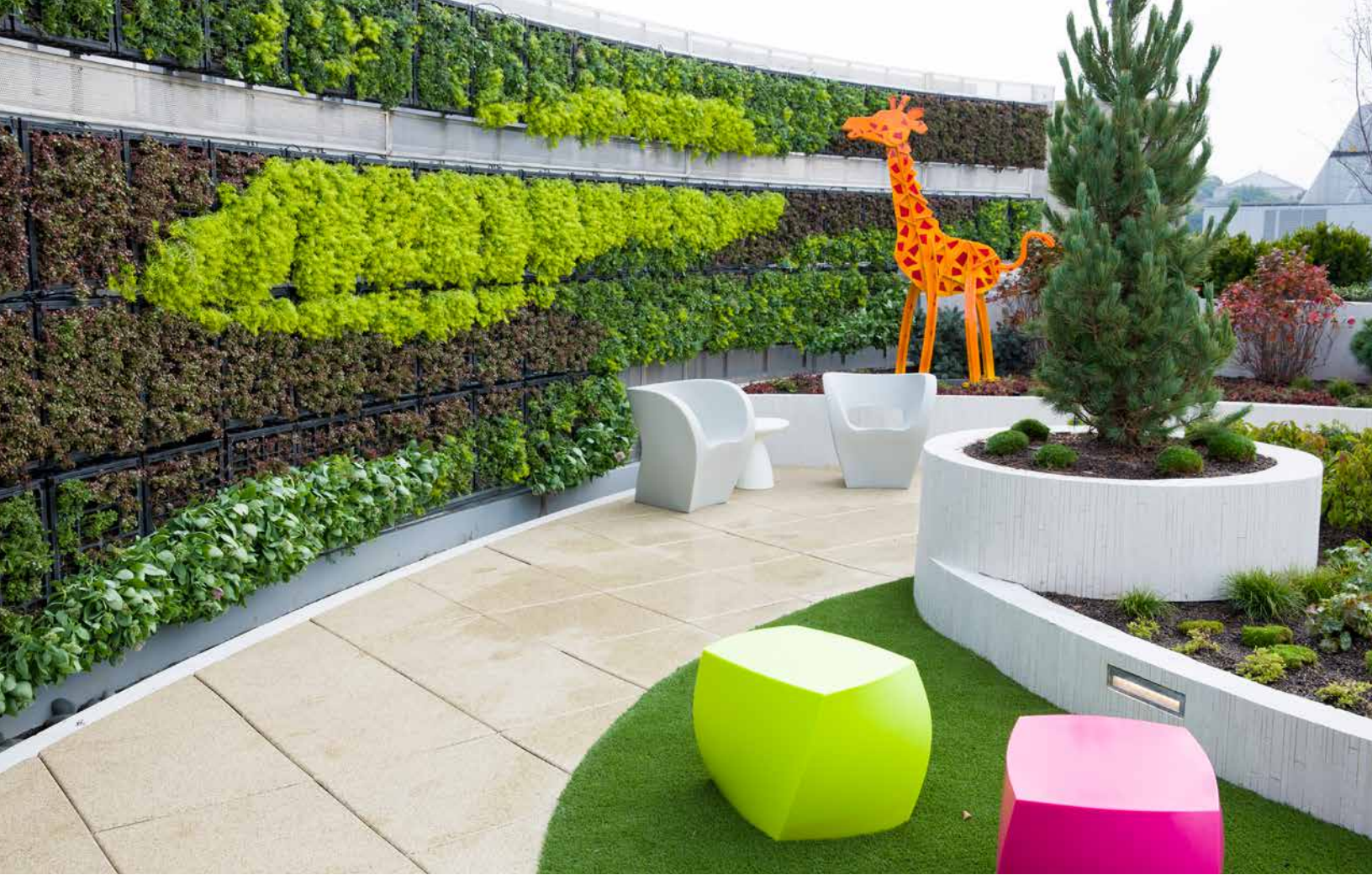

/ Medical University of South Carolina

Charleston, SC

Children's Emergency Department

A unique, child-friendly environment enhances the healthcare experience for children and their families in this modernized facility. The renovation enables the client, ranked in the Top 10 for emergency care, to streamline healthcare delivery with more beds and convenient bedside registration.

Engaging environmental design offers children a welcome distraction from the stresses of treatment. Against a clean and crisp background of soft whites and sunny yellows, vividly colored graphics of sea life welcome patients into exam rooms spaces and give the privacy glass of the Nurses Station a friendlier feel. The inventive theme is integrated throughout the space to enhance wayfinding.

Rosenblum + Coe was Architect of Record.

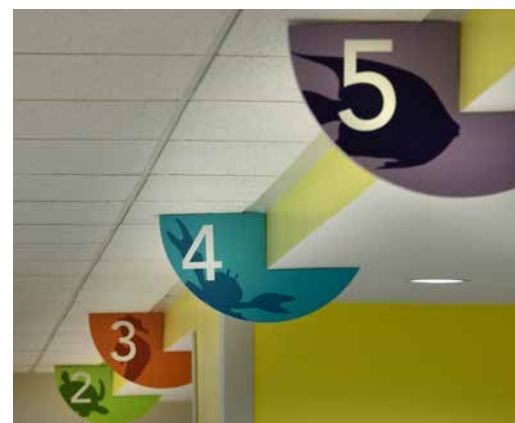

/ Kennedy Krieger Institute Baltimore, MD
Harry and Jeanette Weinberg Center for
Developmental Disabilities



This award-winning facility is an oasis of hope and confidence for children and adolescents with brain and spinal cord difficulties, as well as an affirmation for dedicated caregivers and staff. Dynamic design seamlessly integrates building, interior, and landscape to create a holistic healing environment. The new building collocates research, education, and therapeutic outpatient services that had previously been housed in scattered locations of the Kennedy Krieger Institute, an affiliate of the Johns Hopkins School of Medicine.

Glass walls advance the Center's mission by showcasing its work to the city while admitting daylight and views. The block-long therapy garden – organized into distinct "rooms" devoted to mobility activities for young patients, and respite for families and staff – simultaneously respects the need for privacy and proclaims the Center's presence. The design was conceived to express therapy in its form and mass, research in its curtain wall, and hope in its transparency.

Essential facilities, including examination rooms, therapy pools and gyms and a conference center, are accessed through the expansive two-story lobby whose organic shapes, nature-inspired colors, and invitingly tactile materials extend a soothing welcome. A multi-functional treatment area accommodates occupational and physical therapy, speech and audiology therapy, and an Activities of Daily Living (ADL) suite.

- 115,000 GSF
- 40 examination rooms
- Physical therapy, spinal cord therapy & sensory integration gyms
- OT/PT/speech/audiology/ADL suite
- Conference center
- Modern Healthcare/American Institute of Architects Design Award – Honorable Mention
- ASID Design Excellence Award (Healthcare) – Gold
- IIDA Best of the Best Awards (Healthcare) – Top Honor
- *Contract Design Magazine*, Honorable Mention (Healthcare Environment)





/ Baptist Medical Center Jacksonville, FL
J. Wayne and Delores Barr Weaver Tower,
Wolfson Children's Hospital



An expansive new building enables the only full-service, tertiary pediatric hospital serving North Florida, South Georgia and the Florida Panhandle to better meet the needs of its rapidly growing regional population. The design strengthens connectivity with nature to create a pleasant and calming atmosphere that research demonstrates can positively influence patient outcomes.

The lower levels of the tower house specialized spaces including pediatric cardiovascular intensive care; intraoperative MRI and CT scan surgical suites; a new pediatric behavioral health unit; and the Baptist Neuroscience Institute for children and adults. Nature motifs and interactive graphics, highlighting rivers, forests, and grasslands inspired by the surrounding landscape, enhance the building experience to promote a holistic healing environment.

At 300 SF, patient rooms are nearly twice as large as those in the client's existing facilities, comfortably accommodating families in home-like settings whose child-focused designs feature unique animal themes. Exterior horizontal sunscreens along the south-facing curtainwall help manage glare and solar gain, decreasing building load to save energy. The building offers spectacular views of the St. Johns River.

- 300,000 GSF
- 11 stories
- 216 beds
- Intraoperative MRI/CT suites
- Behavioral Health
- Cardiovascular Care
- Hematology/Oncology
- Neurology & Neuroscience
- AB&C FFC, Project of the Year
- ENR Southeast, Best Project (Merit)





/ CHRISTUS Santa Rosa San Antonio, TX
Children's Hospital of San Antonio



Transformational design reinvents an adult and pediatric facility as a family-friendly children's hospital – the first in the region dedicated solely to pediatric care. A translucent “Spirit of the River” feature wall sets a tranquil mood as it guides patients and visitors through the building. Inspired by the therapeutic qualities of water, the design concept suggests hope in the healing process while referencing San Antonio’s River Walk and the client’s missionary legacy.



The parti organizes “on-stage” and “off-stage” circulation spaces to separate clinical care and public spaces from places where staff transfer patients or enjoy quiet breaks to facilitate security, enhance operational efficiencies, and reduce noise within clinical areas. To further improve security, the building now has a single public entry – a new lobby whose informal gathering and dining spaces encircle a sculpturally formed chapel.



Spacious and full of light, private patient rooms offer young patients and their parents a reassuringly home-like atmosphere. Family amenities and educational spaces include a demonstration kitchen, where Child Life Service staff host healthy cooking classes. Phased to minimize disruptions to hospital operations, the project reimagined and relocated nearly every department.



We were Architect of Record and Project Architect in association with Overland Partners of San Antonio.

- 400,000 GSF modernization
- 10,000 GSF new
- 195 beds
- Neonatal Intensive Care
- Pediatric Intensive Care
- Pediatric Intermediate Care
- Hematology/Oncology
- Surgical Suites
- Rehabilitation
- Women’s Services
- Illumination Awards - Award of Merit



/ Children's Healthcare of Atlanta Atlanta, GA
Egleston Campus



Environmental graphic design and interactive features reinvent the hospital experience in this modernized and expanded facility on the Emory University campus. The high-tech, high-touch interiors embody the client's brand as a leader in patient-focused pediatric care.

This family-friendly hospital collocates dozens of specialty clinics to streamline healthcare delivery and enhance the hospital experience for children and their families. Bright and playful nature-themed interiors educate and entertain young patients, distracting them from illness and treatment and giving them a calming sense of control over their own experience.

Design highlights include electronic feature walls in the main lobbies and video aquarium walls incorporating IMAX® film footage. The innovative program includes Nadia's Room, a home-like facility easing patients' transition from hospital care, and the Stair Gym, a six-story staircase that functions as a symbolic and therapeutic mountain climb.

We were Design Architect in collaboration with Architect of Record HKS Architects.

- 473,800 GSF
- 305 beds
- Transplant Center
- Classrooms
- Library
- Parent Lounge
- Broadcast Media Center
- *Contract Design Interiors Award, Healthcare (large)*



/ Children's Healthcare of Atlanta Atlanta, GA
Scottish Rite Campus



Renewed and expanded facilities consolidate dozens of specialty clinics within a family-focused environment to enhance the patient experience and pediatric healthcare delivery. The program features a full complement of amenities for parents and visitors, as well as bright, child-friendly interiors rich in nature-themed education and entertainment.

The design balances high-tech and high-touch to support the highest level of care while helping to mitigate stress. Storytelling walls, murals and other special installations engage children's imagination. Electronic feature walls in the main lobbies, video aquarium walls incorporating IMAX® film footage and similar interactive features serve a therapeutic value by offering young patients a welcome distraction from treatment and the opportunity to take control of their experience.

Unique spaces include Nadia's Room, a home-like facility designed to ease patients' transition from hospital care, and the Stair Gym, a six-story staircase designed as a therapeutic and symbolic mountain climb.

We were Design Architect in collaboration with Architect of Record HKS Architects.

- 392,000 GSF modernization & addition
- 250 beds
- Activities Center
- 5 gardens
- ASID Georgia Chapter Design of Excellence Awards - Healthcare, Gold Award for Product/Custom Design





/ Palmetto Health Columbia, SC
Children's Hospital



Realizing the client's vision for a dedicated facility expressly designed for children, this high-profile project transformed the highly desirable Seven Richland Medical Park building into a new pediatric hospital, creating the region's only children's emergency center. Prominently sited adjacent to the main hospital, the facility collocates inpatient and outpatient children's services in a comfortable, family-centered environment.

Reflecting the client's commitment to the environment as well as its community, the design celebrates the diverse plants and animals in the natural world, establishing a visually experiential relationship to the nearby Riverbanks Zoo and Botanical Gardens. To enhance the healthcare experience and ease the stress of treatment and hospitalization for children and their parents, all patient rooms are private, and the facility provides a range of family amenities. Each floor showcases a different natural habitat, with its own theme color, graphic icons, customized signage, and "discovery wall," to captivate the imagination of children.

JHS Architecture were Architect of Record.

- 150,000 GSF
- 96 beds
- Family Amenities
- Educational Center
- Society for Environmental Graphic Design - Merit Award
- IIDA Best of the Best Awards - Healthcare, Top Honor in Healthcare





Up
Admissions & Registration
Hematology
Oncology



/ CHRISTUS St. Frances Cabrini Hospital

Alexandria, LA

Women's & Children's Hospital with Emergency Dept



To celebrate life in a way that embraces all generations, this facility supports family-focused compassionate care and the most progressive maternity care in central Louisiana. The design supports high-quality, high-tech healthcare with compassion and sensitivity to women of all ages.

We partnered with the client, who was nearly doubling its campus acreage, to develop a strategic framework to guide long-term growth and address short-term hospital needs. The top priorities identified by the master plan were expanding services for women and children and the emergency department. We also recommended an outdoor mall that unites and connects the campus while improving access.

An abundance of natural light and access to the outdoors promote a holistic healing environment. The emergency department features a dedicated healing garden for patient, family and staff. The circular plan of the urgent care area – where treatment rooms radiate out from a central nurse's station – provides 360-degree visibility and maximizes nurses' time with patients by minimizing walking distances.

The healthy healing environment reflects the client's commitment to sustainable design and operations, which has also helped manage operating costs, enhance the building's marketability, and increase staff productivity. In form and materiality, the new construction responds to local architectural vernacular and climate.

- 188,000 GSF
- 4 stories
- 29,000 GSF Emergency Department
- Women's Clinic
- Labor, Delivery, Recovery & Postpartum (LDRP)
- Pediatric Cardiology, Pulmonology, Perinatology & Surgery
- Neonatal Intensive Care Unit





/ pediatric healthcare client list

Nemours/Alfred I Dupont Hospital for Children

Advocate Children's Hospital

Advocate Christ Medical Center

AFLAC Cancer Center at Egleston

Augusta University, Children's Hospital of Georgia

Baptist Medical Center Wolfson Children's Hospital

Bradley Children's Hospital

Children's Healthcare of Atlanta - Scottish Rite

Children's Healthcare of Atlanta - Egleston

Children's Hospital of New Orleans

Children's Hospital of Philadelphia

Children's Hospital of San Antonio

Children's Medical Center, Charlotte

Children's Medical Center of Dallas

Hasbro Children's Hospital

Joe DiMaggio Children's Hospital

Kennedy Krieger Institute

Mayo Clinic/Rochester - Children's Clinic

Medical University of South Carolina Pediatric Emergency

Mission Hospitals Reuter Children's Outpatient Center

Nemours Children's Hospital

Nicklaus Children's Hospital

OSF/Children's Hospital of Illinois

Palmetto Health Children's Hospital

Ronald McDonald House Charities

Shawnee Mission Health B. E. Smith Children's Pavilion

St. Jude Children's Research Hospital

Stamford Health

The University of Iowa Children's Hospital

University Hospitals Rainbow Babies Children's Hospital

University of Chicago Hospitals Comer Children's Hospital

University of Louisville Novak Center

University of Virginia Battle Building Outpatient Center

University of Virginia Hospitals Children's Master Plan

Wake Forest University Brenner Children's Hospital



/ awards & honors

2017 IES (Illuminating Engineering Society of North America) Illumination Award

St. Jude Children's Research Hospital Kay Research and Care Center

2017 IIDA Award for Healthcare Renovation - Tennessee Chapter

St. Jude Children's Research Hospital Kay Research and Care Center

2017 IIDA Best of All Design - Tennessee Chapter

St. Jude Children's Research Hospital Kay Research and Care Center

2017 Design Showcase Award of Merit

The Buerger Center for Advanced Pediatric Care Children's Hospital of Philadelphia

2017 Illumination Awards - Award of Merit

Children's Hospital of San Antonio

2017 IIDA Best of the Best Awards - Overall

St. Jude Children's Research Hospital Kay Research and Care Center

2017 IIDA Best of the Best Awards - Large Healthcare

St. Jude Children's Research Hospital Kay Research and Care Center

2016 The Chicago Athenaeum American Architecture Award

OSF Saint Francis Medical Center Children's Hospital of Illinois

2015 Healthcare Environment Award by Contract Magazine - Honorable Mention

Angie Fowler Adolescent & Young Adult Cancer Institute

2015 AIA GA Design Awards – Merit Award

Nemours Children's Hospital

2015 IIDA Best of the Best Awards -

Small Healthcare

Rainbow Babies & Children's Hospital Angie Fowler Adolescent & Young Adult Cancer Center

2015 IIDA Best of the Best Awards -

Healthcare Award of Merit Large Healthcare

The Battle Building at the University of Virginia

2014 AIA Honor Award - Richmond, Virginia

University of Virginia Battle Building

2014 Associated Builders and Contractors FFC Chapter Project of the Year Award

Weaver Tower at Baptist Medical Center

2013 Interior Design Best of the Year Finalist- Healthcare Category

Nemours Children's Hospital

2013 ENR Southeast - Best in Healthcare Project

Nemours Children's Hospital

2013 ENR Southeast - Project of the Year

Nemours Children's Hospital

2013 ENR Southeast - Award of Merit for Safety

Nemours Children's Hospital

2013 ENR Southeast - Best Project - Award of Merit

Weaver Tower at Baptist Medical Center

2013 ABC Central Florida – Best Healthcare

Nemours Children's Hospital

2013 ABC Excellence in Construction – Project of the Year

Nemours Children's Hospital

2013 Healthcare Design Renovation - Best in Category

Children's Healthcare of Atlanta Nadia's Room

2013 Symposium Distinction Awards - User-Centered Award

Nemours Children's Hospital

2013 ASLA Florida Chapter - Award of Excellence

Nemours Children's Hospital

2013 ASHRAE Chapter Technology Award – Central Florida

Nemours Children's Hospital

2013 AIA - Orlando Design Award of Honor

Nemours Children's Hospital

2013 International Design Award - Honorable Mention

Nemours Children's Hospital

2013 IIDA Best of the Best Awards - Healthcare

Top Honor in Healthcare for Nemours Children's Hospital

2013 IIDA Best of the Best Awards - Overall

Top Honor Overall for Nemours Children's Hospital

2011 Modern Healthcare Design Award - Unbuilt Category

Nemours Children's Hospital

2011 Society of Environmental Graphic Design - Merit Award

Palmetto Health Children's Hospital

2010 Bently Systems Be-Inspired Awards

Advancing Interoperability Award - Nemours Foundation

/ awards & honors

2010 ASID Design Excellence Award - Healthcare

Kennedy Krieger Institute - Gold

2010 IIDA Best of the Best Awards - Healthcare

Top Honor in Healthcare for Kennedy Krieger Institute

2009 Contract Design Magazine Healthcare

Environment - Honorable Mention

Kennedy Krieger Institute

2009 Modern Healthcare/American Institute of Architects

Design Award - Honorable Mention -

Kennedy Krieger Institute

2009 IIDA Best of the Best Awards - Healthcare

Top Honor in Healthcare for Palmetto Health

Children's Hospital

2008 Interiors Awards in Large Healthcare by Contract

Citation - Children's Healthcare of Atlanta

2008 IIDA Best of the Best Awards - Healthcare

Best of the Best Overall Award -

Children's Healthcare of Atlanta

Top Honor in Healthcare -

Children's Healthcare of Atlanta

2007 Georgia American Institute of Architects -

Design Citation

Children's Healthcare of Atlanta - Interiors

2007 ASID Georgia Chapter Design of Excellence Awards - Healthcare

Gold Award for Product/Custom Design - Children's Healthcare of Atlanta - Scottish Rite

Silver Award - Reuter Children's Outpatient Center

2007 Healthcare Environment Award by Contract

Magazine - Honorable Mention

Children's Healthcare of Atlanta

2006 Modern Healthcare/American Institute of Architects

Design Award - Honorable Mention -

Reuter Children's Outpatient Center

2006 The Center for Health Design Annual Healthcare Environment Award

Citation - The University of Chicago Hospitals Comer

Children's Hospital

2005 American School & University Architectural

Competition

Citation - Comer Children's Hospital at the University of Chicago

2000 Modern Healthcare/American Institute of Architects

Design Award - top design award- Augusta University Children's Hospital of Georgia

2000 South Atlantic Regional Conference Merit Award - Interiors

Augusta University Children's Hospital of Georgia

1999 Metal Construction Association Scholarship Award

Augusta University Children's Hospital of Georgia

1999 Metal Construction Association President's Award

Augusta University Children's Hospital of Georgia

1998 The National Symposium on Healthcare Design

The 10th Annual Healthcare Environment Award

AFLAC Cancer Center at Children's Healthcare of Atlanta

1998 Modern Healthcare/American Institute of Architects

Design Award - top design award

AFLAC Cancer Center at Children's Healthcare of Atlanta

1998 Sixth Annual International Interior Design Acclaim

Awards/Los Angeles

Augusta University Children's Hospital of Georgia

First Place Award for custom upholstery design -

Deepa Textiles

Honorable Mention for custom cubicle curtain design -

Deepa Textiles

1997 Modern Healthcare/American Institute of Architects

Design Award- Top Design Award in "Unbuilt" Category

Augusta University Children's Hospital of Georgia

1993 The National Symposium on Healthcare Design

The 5th Annual Healthcare Environment Award

Cardiac Intensive Care Unit at the

Children's Healthcare of Atlanta

/ capabilities

Architecture

- Design
- Planning
- Programming
- Interior Design
- Life Safety
- Signage & Wayfinding
- Workplace Strategy & Design
- Master Planning

Energy

- Energy Data Analysis
 - Energy modeling
 - Benchmarking
- DSM Programs for Utilities
- Building Performance Optimization
 - Energy Audits
 - Energy Master Plans
 - Retro-commissioning

Engineering

- Electrical
- Fire Protection
- Mechanical
- Plumbing
- Security
- Structural
- Telecommunications

Software

- B3 Benchmarking
- NEO Net Energy Optimizer®
- Custom tools with WeidtSim®

Consulting

- Graphic & Environmental Design
- Marketing Communications
- Public Relations

/ about EYP

EYP is a global provider of comprehensive high-performance building design, research, and consulting services. We are five sectors – Higher Education, Government, Healthcare, Science & Technology, and Energy – who work as one firm to help our clients address some of the most critical issues facing our nation and our world. Our professionals work across 15 offices in the United States and Europe.

The only firm to have been ranked #1 for energy and sustainability for two consecutive years by *Architect Magazine*, EYP is committed to creating rich, productive, and inspiring environments that promote human well-being, preserve natural resources, and provide flexibility and resilience for the future. Our knowledge-based innovation strategy helps promote action-oriented public dialogue about the future of the built environment.

Disciplines

Architecture, Engineering, Energy, Environmental Graphic Design, Interior Design, Master Planning

Integrated Design Expertise

- Academic Innovation
- Embassies
- Energy & Sustainability
- Health Education
- Healthcare
- Historic Preservation
- Libraries
- Master Planning
- Mission Critical
- Modernization
- Science & Technology
- STEM
- Student Life
- Workplace

Research

The right building design can help organizations advance their mission and goals. Our research program makes us better designers and more valuable advisors to our clients – and helps our clients make more strategic decisions about their buildings. Our open innovation approach values collective intelligence. We partner with outside experts in many disciplines to transcend the limits of current thinking and expectations, collaboratively exploring and testing ideas in Building Science, Energy, Healthcare Design, Living-Learning, STEM, and Workplace.

Recognition

- 2016 Architect 50 – *Architect Magazine*
- 2016 Top 25 Architecture Firms – *Architectural Record*
- 2016 Top 25 Architecture & Engineering Firms – *Engineering News-Record*
- 2016 MEP Giants – *Consulting-Specifying Engineer*
- 2016 Giants 300 – *Building Design + Construction*
- 2016 Top 500 Design Firms – *Engineering News-Record*
- 2016 Top Architects – #1 for Healthcare Renovation – *Health Facilities Construction Quarterly*
- 2012-2015 AIA National IDP Outstanding Firm Award

EYP/HEALTH

WHR ARCHITECTS | STANLEY BEAMAN & SEARS

eypae.com/healthcare

design for your people, your purpose, our planet