

Higher Education Master Planning

EYP/®

EYP is the leading architecture and engineering firm developing new ideas and design solutions with mission-driven clients in higher education, government, healthcare, and science & technology.

Our clients are in the business of changing lives for the better: promoting peace and prosperity; educating the next generation; transforming the healthcare experience; driving discovery and innovation; and protecting the environment. They expect their buildings to have as profound an impact on human behavior and performance as they do on energy and the environment – that’s why they come to EYP.

We believe the built environment empowers our clients to succeed – as individuals and organizations – and that their success should be a key measure of building performance. Our interdisciplinary Total Impact Design™ approach helps clients achieve their mission.

We begin by understanding the “whys” driving every client’s vision, needs, and goals. We encourage our clients to be ambitious – to imagine a future where expectations are achieved and even surpassed. The design we co-create is realized through creative collaboration and an iterative process tested and informed by rigorous research. Long after project completion, we continue to partner with clients to measure and analyze how a building contributes to the ongoing success of their mission.

EYP design innovation is characterized by our dedication to:

People – *liberating potential to transform human performance*

Purpose – *actively helping clients advance their mission*

Planet – *maximizing available resources to advance sustainability*

Inspired by our clients, design is how we make a positive impact on the world.

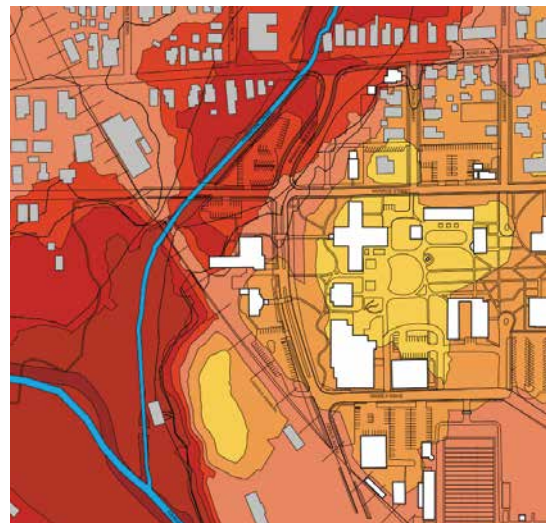

MASTER PLANNING

Our master planning approach is mission and purpose based, geared toward our clients' fundamental objectives. Our work strives to reflect an appreciation of uniqueness and authenticity in the spirit of the place. Through practiced discipline — study, collaboration, and consensus building — we create forward-thinking, practical frameworks with the power to realize each institution's vision. We begin by understanding our clients' goals, needs, and resources in relation to their aspirations and challenges such as sustainability, market competition, demographic trends, and security. The perspective we gain enables us to identify and evaluate the best alternatives for long-term development.

Contact

John Baxter, AIA, LEED AP
202 471 5050 / jbaxter@eypae.com

Franklin College Franklin, IN

Campus Master Plan Update

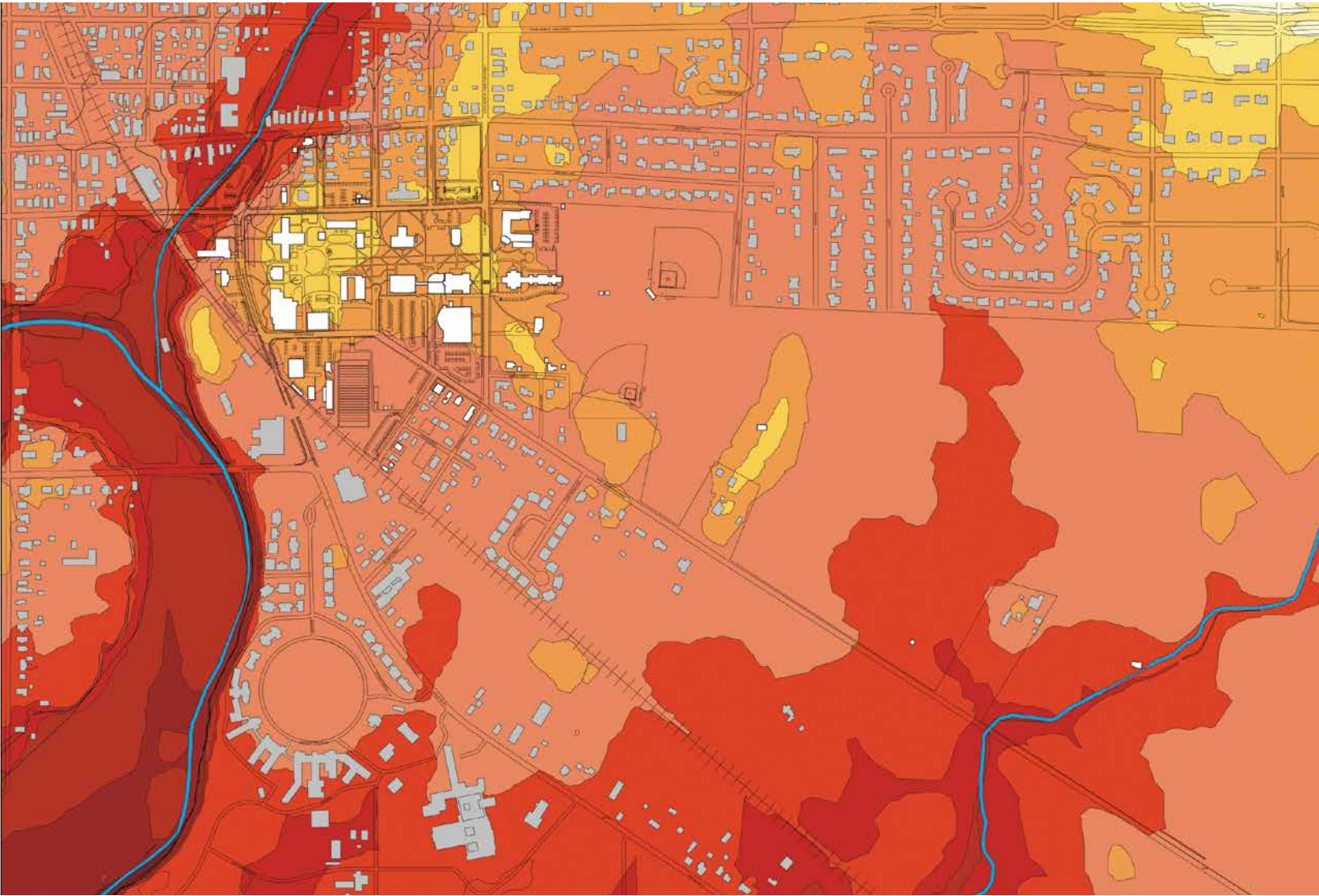

To advance its mission and strategic plan, the College required a framework for sustainable development to preserve the historic character of its core campus and its integrated land-use and open space patterns.

EYP assisted the College in defining building requirements and identifying optimal sites for new construction and landscape improvements. Planning studies encompassed site analysis and design; building condition and energy survey; preparation of a space inventory database and space utilization analyses; and facility programming.

Franklin's new master plan reflects the campus's 175-year evolution along the principles of Thomas Jefferson's academical village. To meet the College's goals for reducing greenhouse gas emissions, the plan features projects for recycling as well as reinvigorating existing buildings or expanding them where program requirements substantiate the need for additional space. Land development proposals create athletic and recreational fields on recently acquired acreage east of the core campus.

- Founded 1834
- Enrollment: 1,050
- No. Buildings: 24
- GSF: 535,721
- Acreage: 345

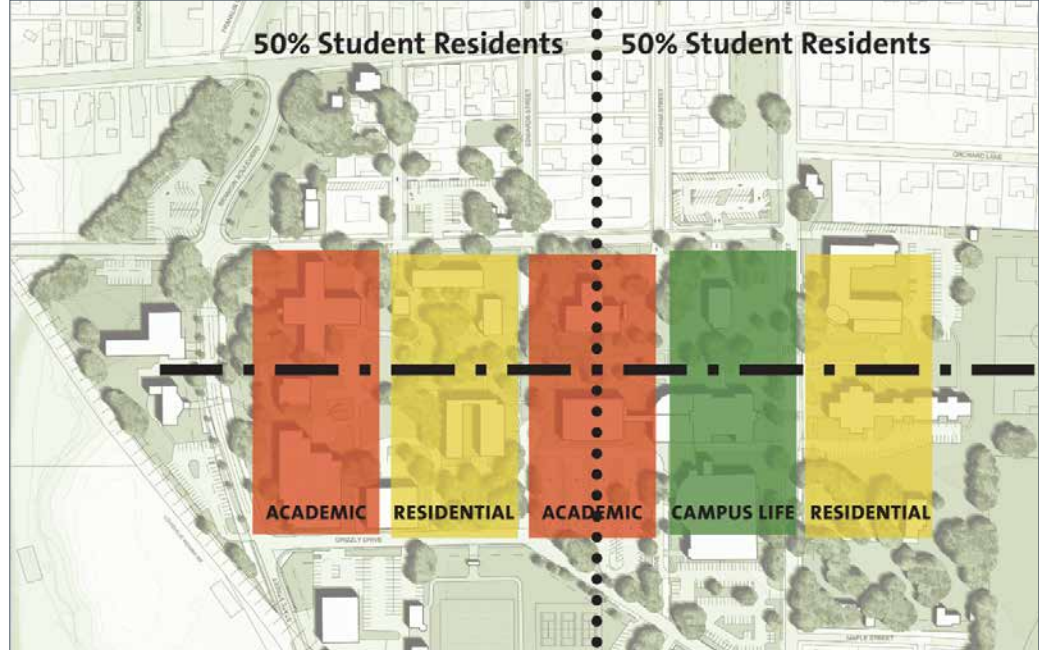

Land Use Pattern



Core Open Space





Rockhurst University Kansas City, MO

Campus Master Plan



To strengthen its identity as an inclusive community resource and to maximize a constrained urban campus, Rockhurst needed to create a compelling vision to advance academic excellence through reasoned development.

Our multidisciplinary team helped the University plan for program development while relating to its residential and commercial context. Proposed buildings along a major avenue will introduce retail spaces or activities, contributing to the local economy and creating a more porous campus edge that encourages visitors. A donor walk will draw pedestrians across campus green spaces. Sustainable elements such as rain gardens and green roofs will create a more pleasant, sustainable campus, while six sacred spaces will invite quiet reflection. Renovation of historic Sedgwick Hall with addition of a winter garden will establish a new campus focal point.

Rockhurst's plan positions the University as a collaborative community partner that will help advance civic development through its campus renewal.

- Founded: 1910
- Enrollment: 2,350
- No. Buildings: 23
- GSF: 648,459
- Acreage: 62

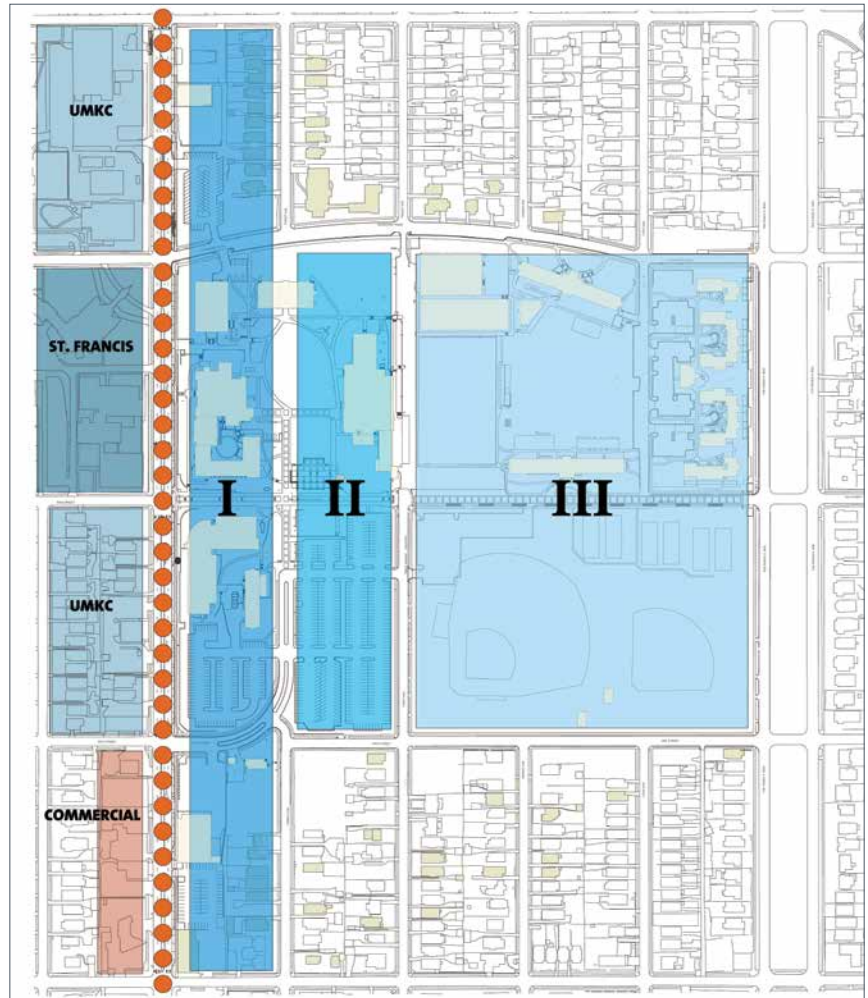

Proposed Campus Development Zones

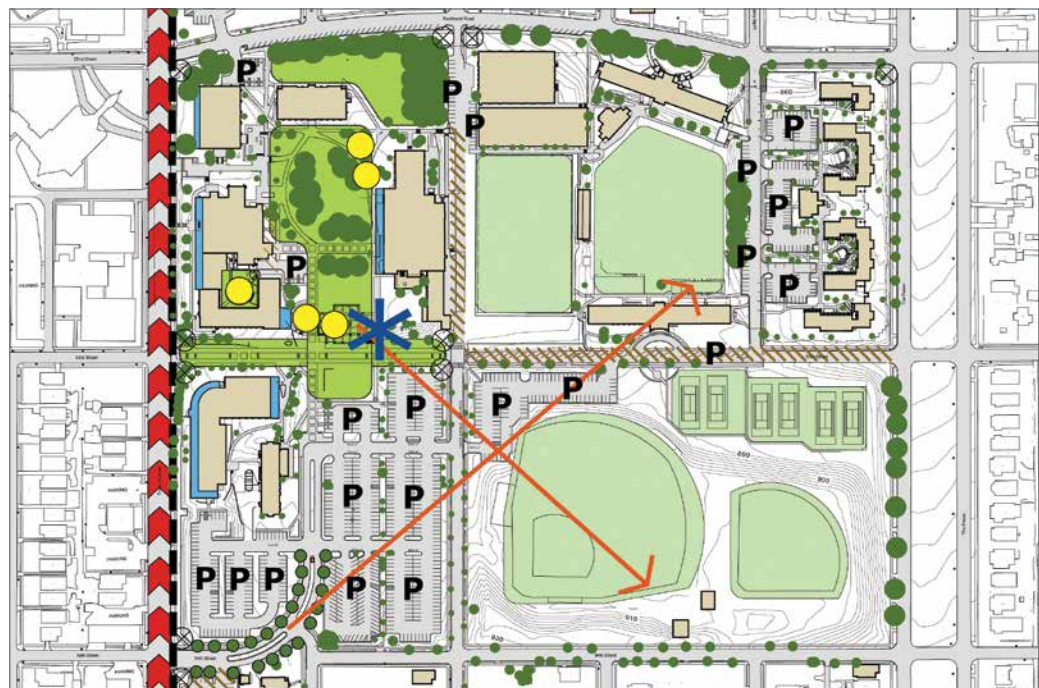

Detail / Existing Design Features



Chatham University Pittsburgh, PA

Campus Master Plan



As an early signatory of the Presidents Climate Commitment, the University required a strategic framework to guide sustainable development of its core campus as well as establishment of a satellite location within a nearby urban redevelopment district.

Campus planning studies undertook a complete update of the campus space inventory database and an intensive utilization analysis of all instructional space. Featured proposals included: access enhancements; energy-savings measures; intensified building reuses and space reallocations; and a focused program for landscape refurbishment.

The plan underscores Chatham's identity as a champion of environmental responsibility, while establishing the magnitude of space required for relocation of graduate programs to an urban redevelopment district, a strategic initiative to advance graduate programs and the institution's profile. The interim phase of the plan embraces a near-term no-build strategy. Sites for new construction were identified in anticipation of the long-term development of the Shady Side campus.

- Founded: 1869
- Enrollment: 1,310
- No. Buildings: 30
- GSF: 602,656
- Acreage: 38

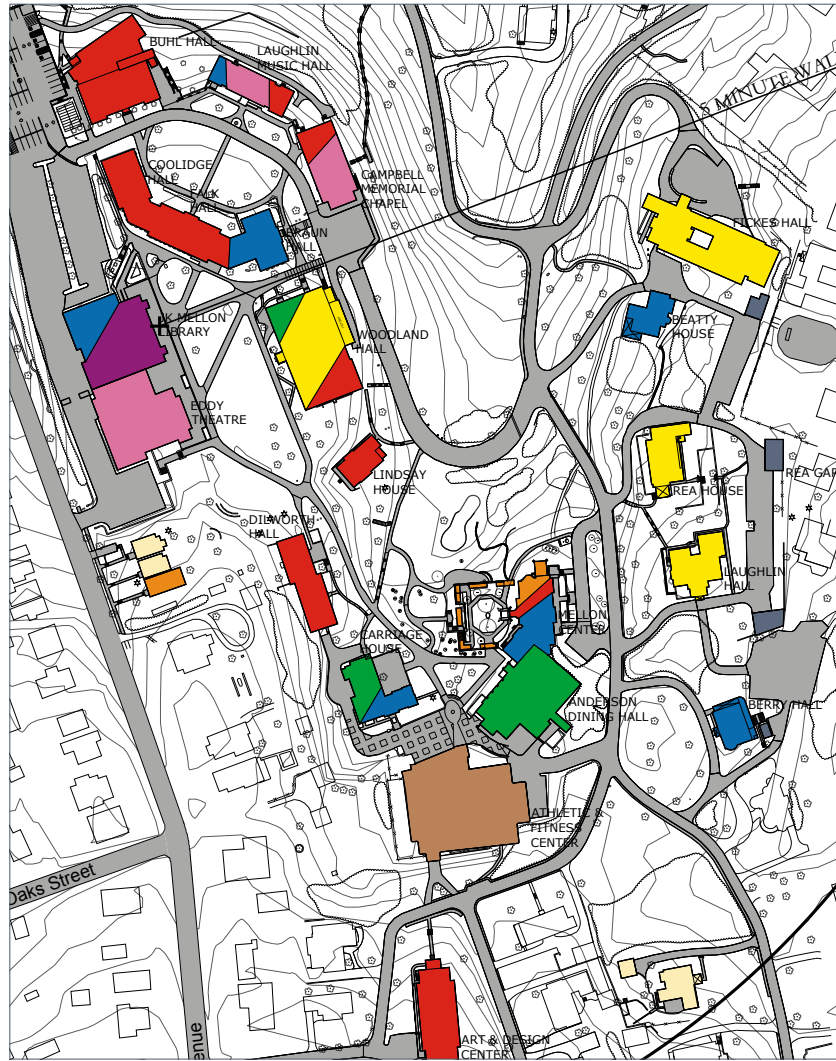

Detail / Existing Building Uses

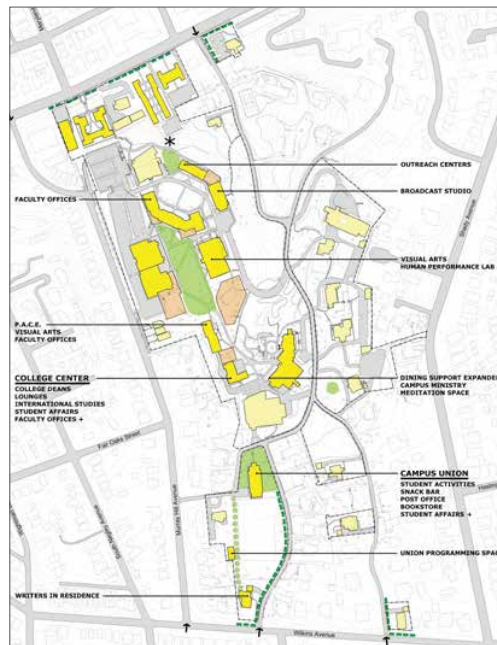

No-build Reuse / Option 1

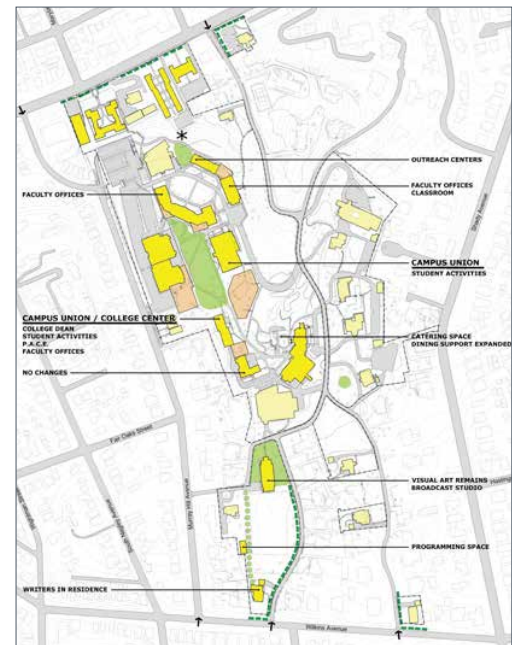

No-build Reuse / Option 2



Columbia University Medical Center New York, NY

Mailman School of Public Health Master Plan

Columbia University's Mailman School of Public Health asked EYP to help them develop a strategic plan to aid the school in meeting its current space needs, anticipated growth, and strategic initiatives as well as assess its existing space utilization. Challenged with its current space on the Medical Center campus and its offsite locations, EYP strategically reviewed the school as a whole in an effort to map, analyze, and plan how to best utilize existing space as well as the need for growth into new space.

Key planning goals include:

- Accommodate growth and change
- Consolidate space when and where possible
- Create space for cross-collaboration across the school
- Create a "home" for departments, centers and students and provide a sense of "identity" for the school.
- Incorporate current real estate opportunities and constraints
- Generate a better classroom experience

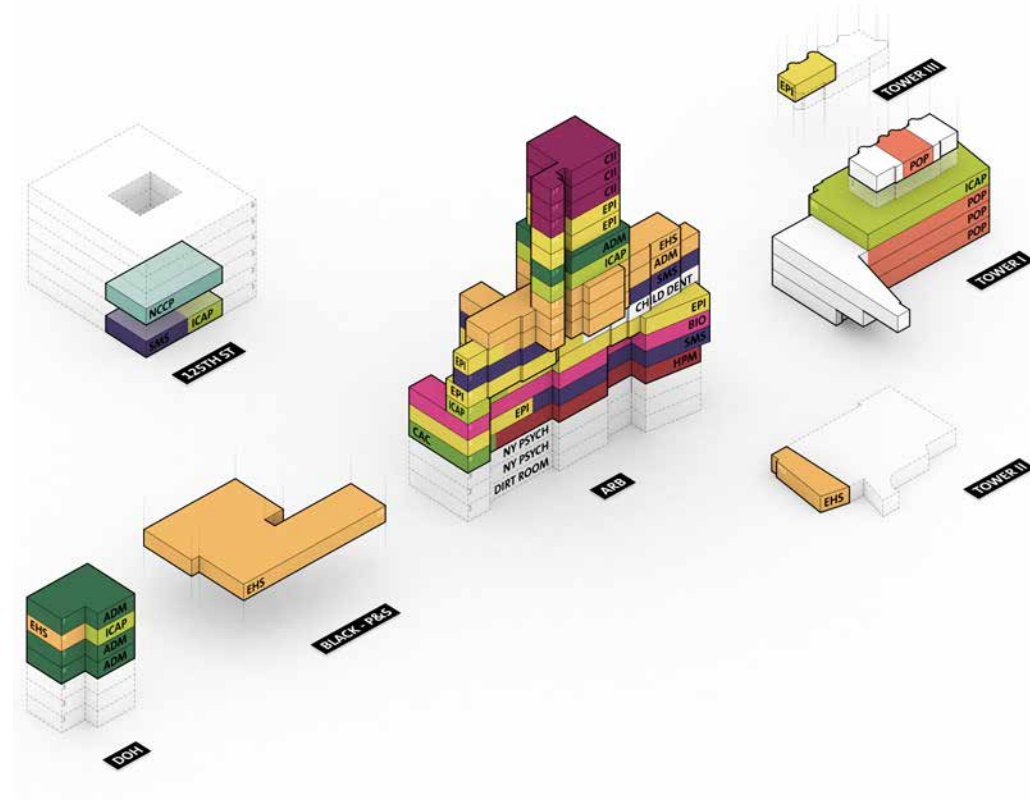

The master planning process includes a vision session, engagement with key stakeholders, and work sessions to review data. The final deliverable is a Strategic Space Plan Report, which outlines three options for the school to consider a "preferred option" with associated schedule, phasing and costs.

- Programming, Master planning, workplace strategy
- 170,000 GSF analysis

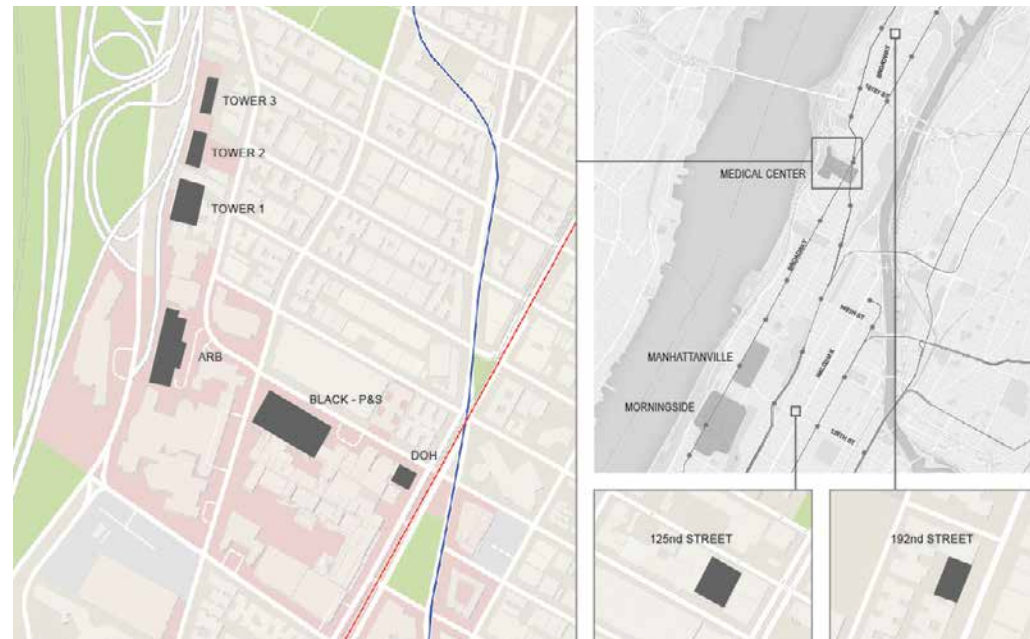

Harvard University Cambridge, MA

Strategic Plan for Housing Renewal



We partnered with the University to develop programming, technical, preservation, and sustainability guidelines to ensure the capacity of the historic House system to fulfill its mission while preserving its historic fabric. Our report consistently sets forth the process, program, and technical aspects of House renewal; establishes appropriate benchmarks for the University's decision-makers during the renewal program; and provides parity and equity in design approach among the individual House renewal projects. On the basis of the Winthrop House energy model, the guidelines anticipate major strategic achievements that will help the University meet its goal of reducing total greenhouse gas emissions by 30 percent.

To develop an understanding of the existing conditions of the Houses (totaling approximately 2 million square feet), our architects, engineers, and preservationists thoroughly assessed four representative buildings. Findings demonstrated that potentially failing systems required replacement to such an extent that buildings would have to be brought up to current code and accessibility standards, providing an opportunity for the College to renew its residential life program.

Based on the goals and programmatic needs established in meetings with a wide variety of constituents, we developed a program which was test-fitted into existing buildings to confirm that bed capacity, unit mix, and community space needs could be accommodated. This effort was complemented by a survey of important cultural resources within and around the Houses.

- 2,400,000 SF
- Programming & Planning

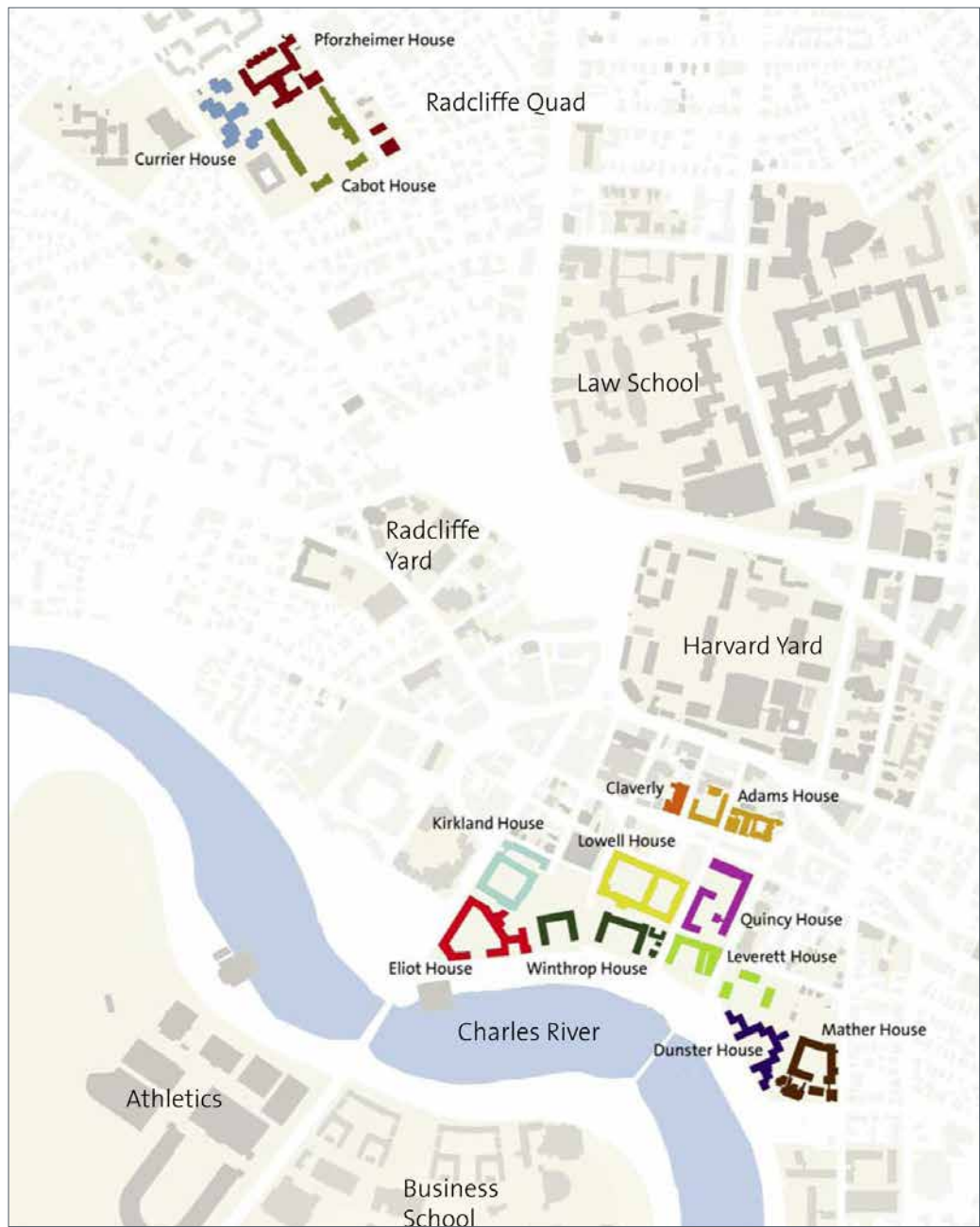



Roger Williams University Bristol, RI

Campus Master Plan

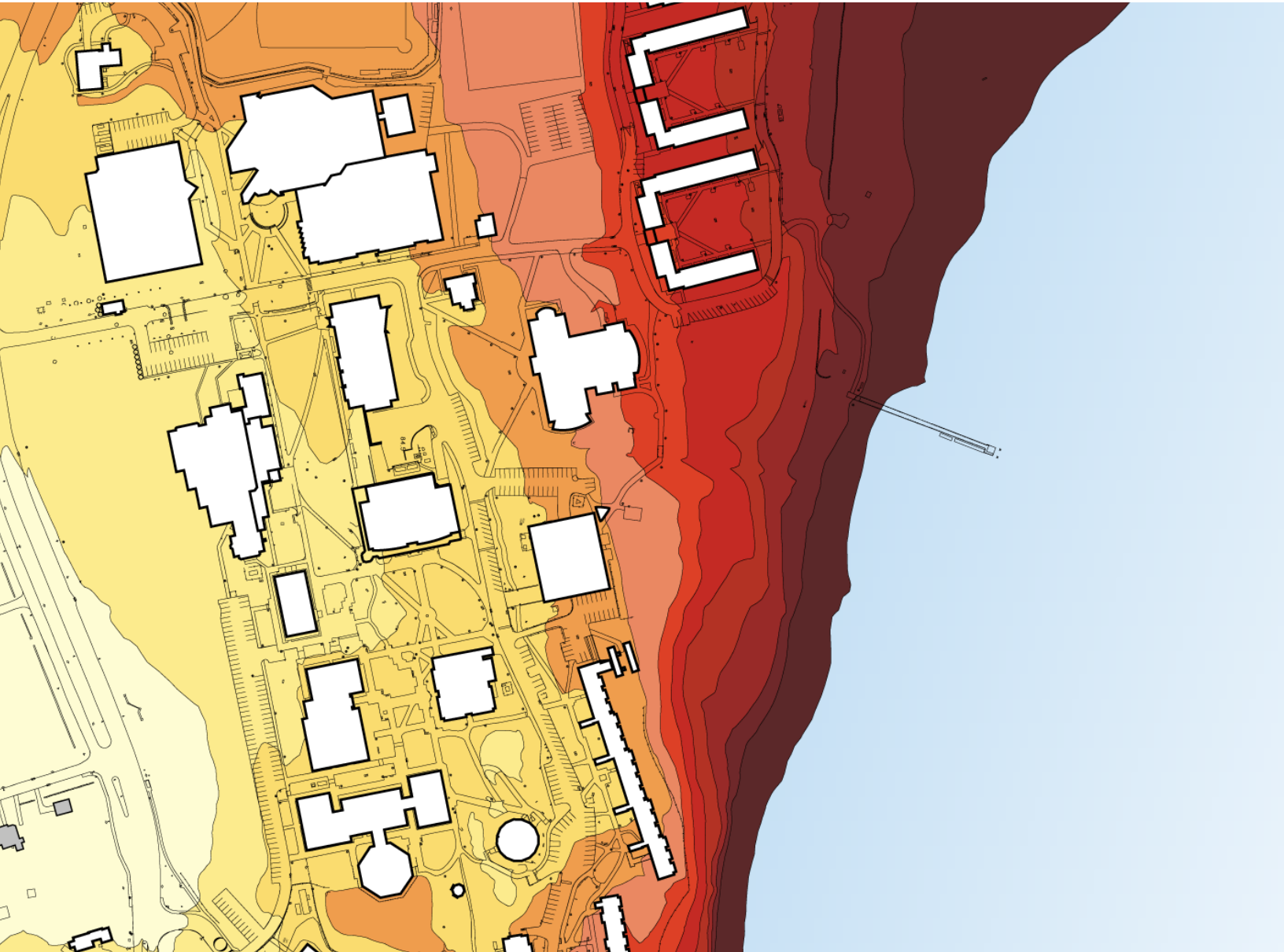

The University required a comprehensive master plan to support its strategic goals for sustainable land development to consolidate undergraduate student housing on campus and create appropriate academic program space, including classrooms and library facilities.

EYP provided a framework for developing the site and buildings appropriate to the institution's image and strategic goals. Our team analyzed both current and planned facilities and offered recommendations on potential energy efficiency gains as well as alternative and renewable energy sources. Initiatives are cast for a ten-year timeframe within the context of a twenty-year land development strategy.

The master plan provides the University with a functional framework for sustainable growth to create spaces suitable to its distinctive academic programs.

- Founded: 1956
- Enrollment: 4,000
- No. Buildings: 38
- GSF: 1,198,630
- Acreage: 144

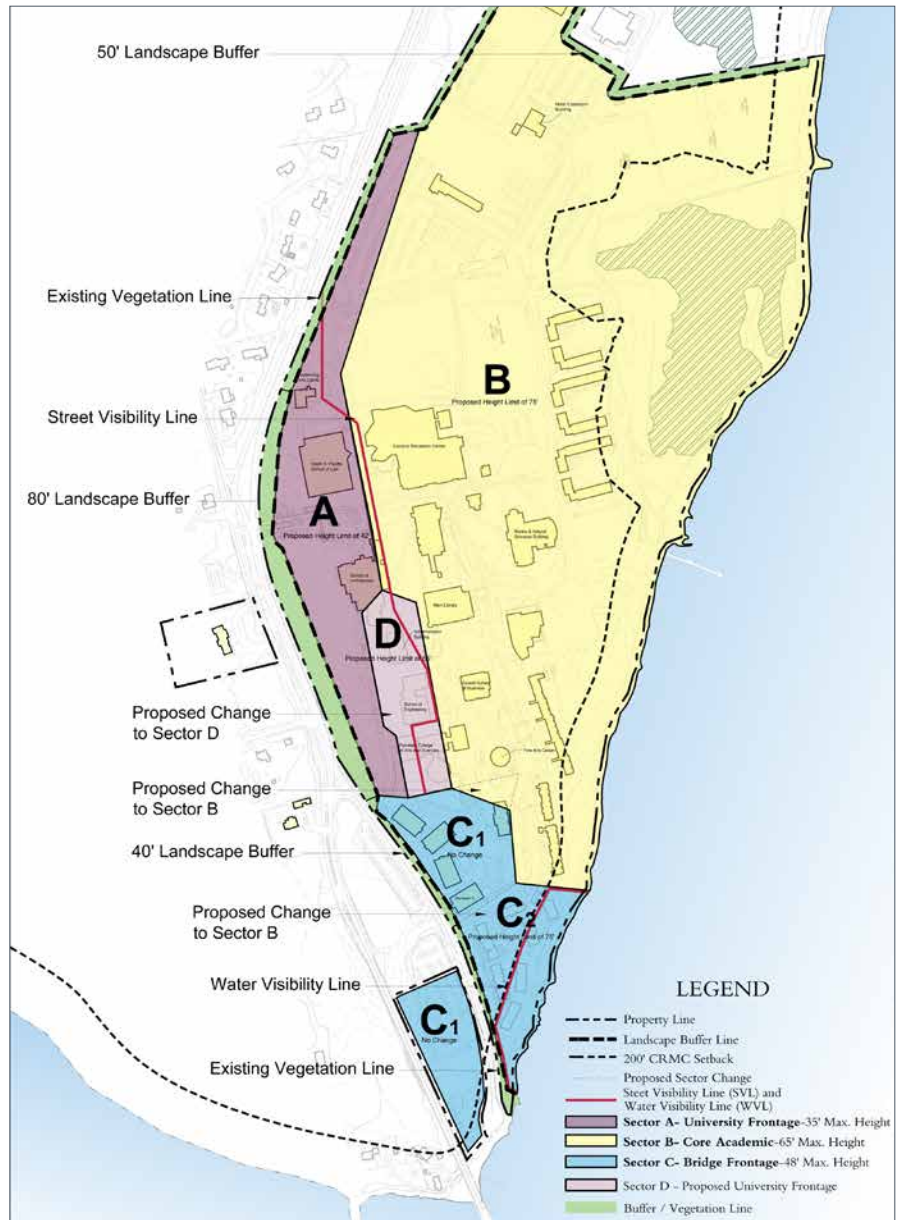

Zoning Study

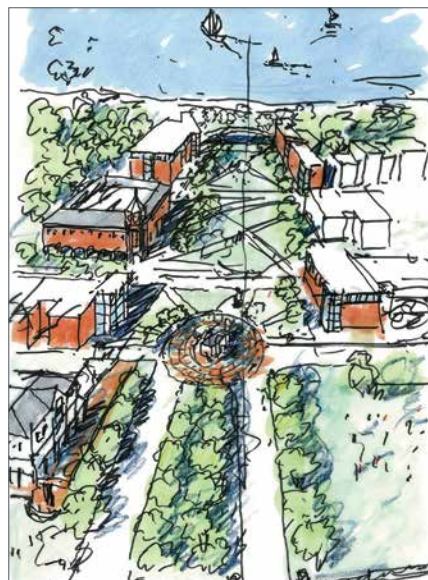

Concept Option

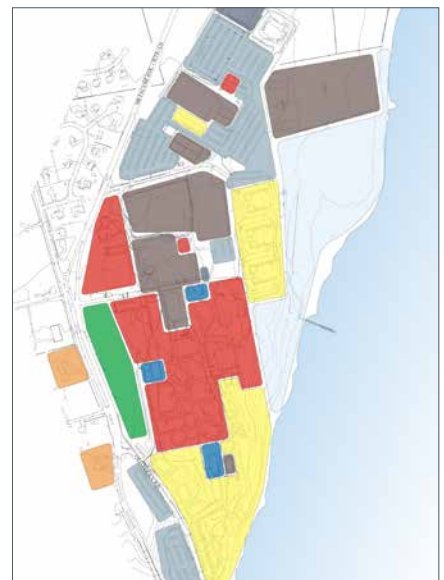

Land Uses



Harvard University Cambridge, MA

Kennedy School of Government Facility Planning Study

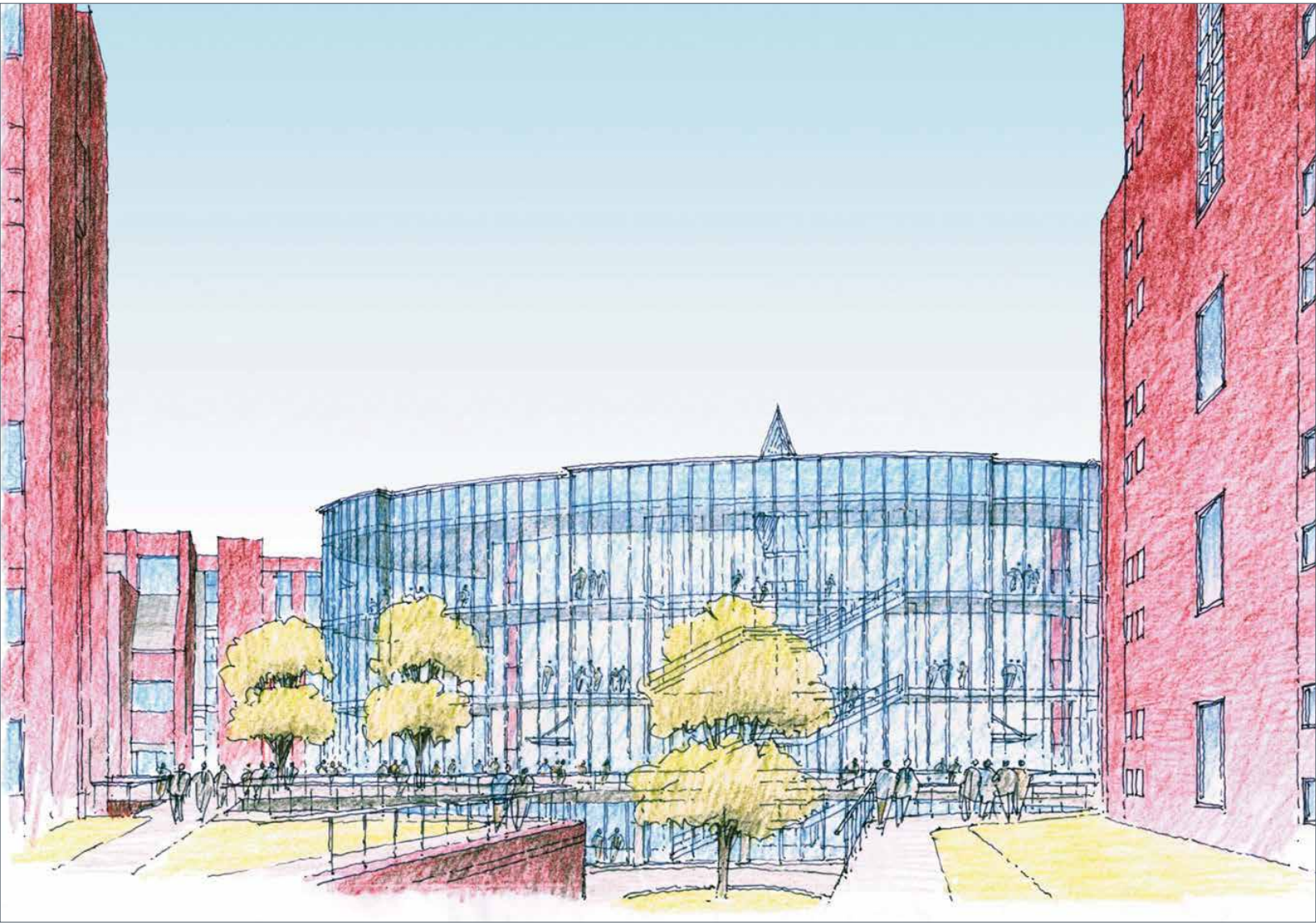

The School needed to assess its existing facilities and space utilization to develop a strategy for near-term improvement with a view toward the long-term potential for campus development.

Our multidisciplinary team provided short-term and long-term improvement plans for Harvard Kennedy School classrooms and teaching spaces. Our design exploration tested alternative concepts and the capacity of the existing core campus for long-term space use and development.

EYP created a strategic space program that encompasses the entire HKS campus. We were subsequently commissioned by the University to undertake the first classroom improvement project, the renovation of Weiner Auditorium in Taubman Hall.

- Founded: 1936
- Enrollment: 1,020
- No. Buildings: 4 Main Campus
- GSF: 214,754
- Acreage: 2.9



District Zoning

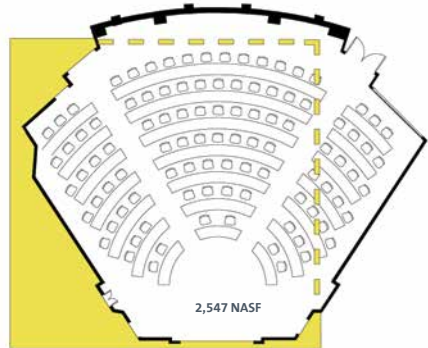

Classroom Analysis



Microclimate Study



Existing Space Uses

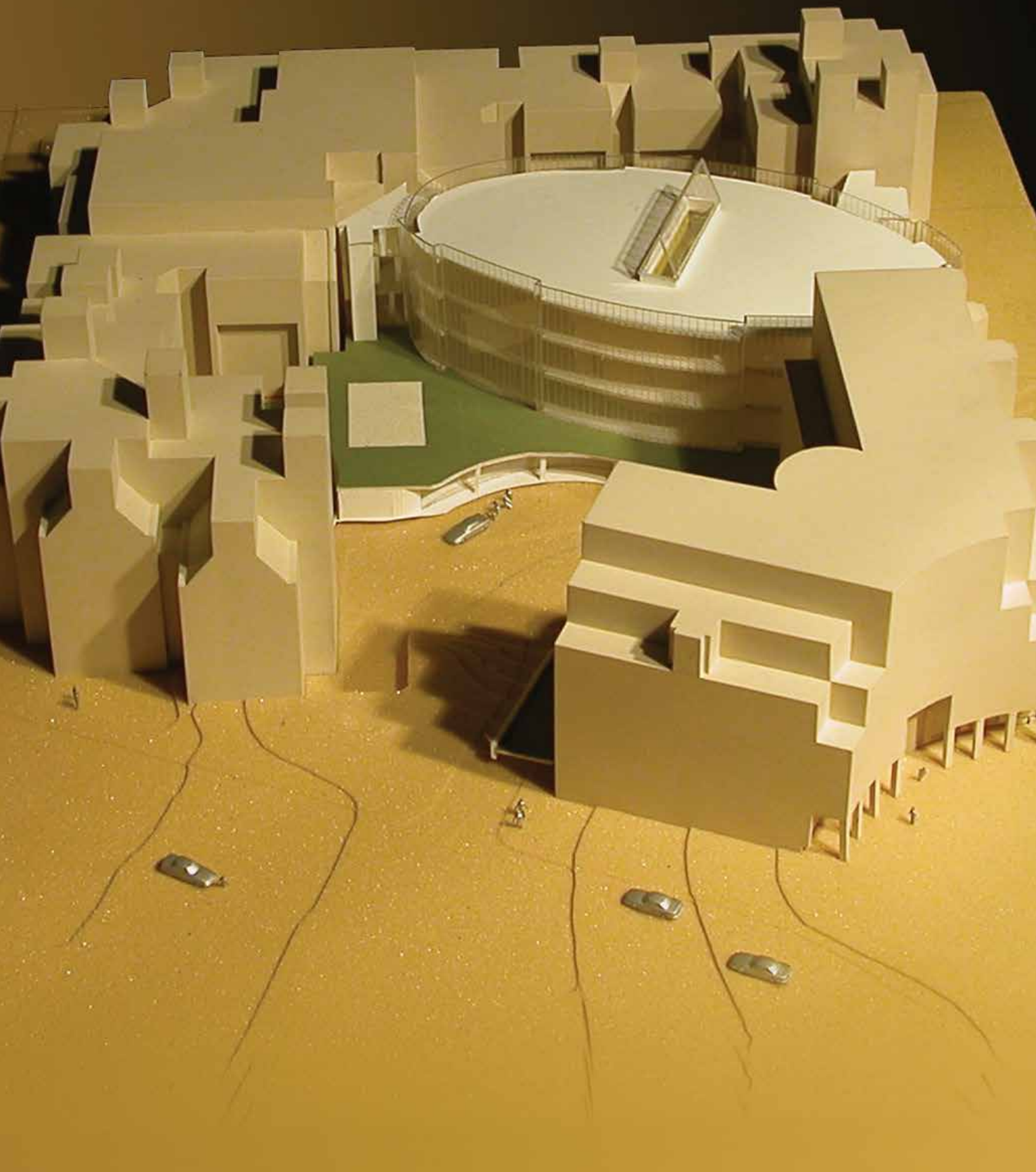

The College of New Jersey Ewing, NJ

Campus Academic and Administrative Facilities Master Plan



The College of New Jersey sought a campus master plan that could help achieve its strategic goals, including, enrollment growth; enhancement of the residential experience; the living/learning environment; and meeting its aspirations for sustainability and energy efficiency.

The master plan for the College's academic precinct encompasses seven different departments housed in eight campus buildings. EYP provided programming, concept development, and prioritizing schedules for building replacement, renovation, and new construction.

The College's master plan provides a unified and integrated solution to functional obsolescence in a systematic, prudent, and purposeful manner to advance the mission and aspirations of the College.

- Founded: 1855
- Enrollment: 5,600
- No. buildings: 60+
- GSF: 2,750,000
- Acreage: 289



2012 - 2014



2015 - 2017



Saint Joseph College West Hartford, CT

Master Plan

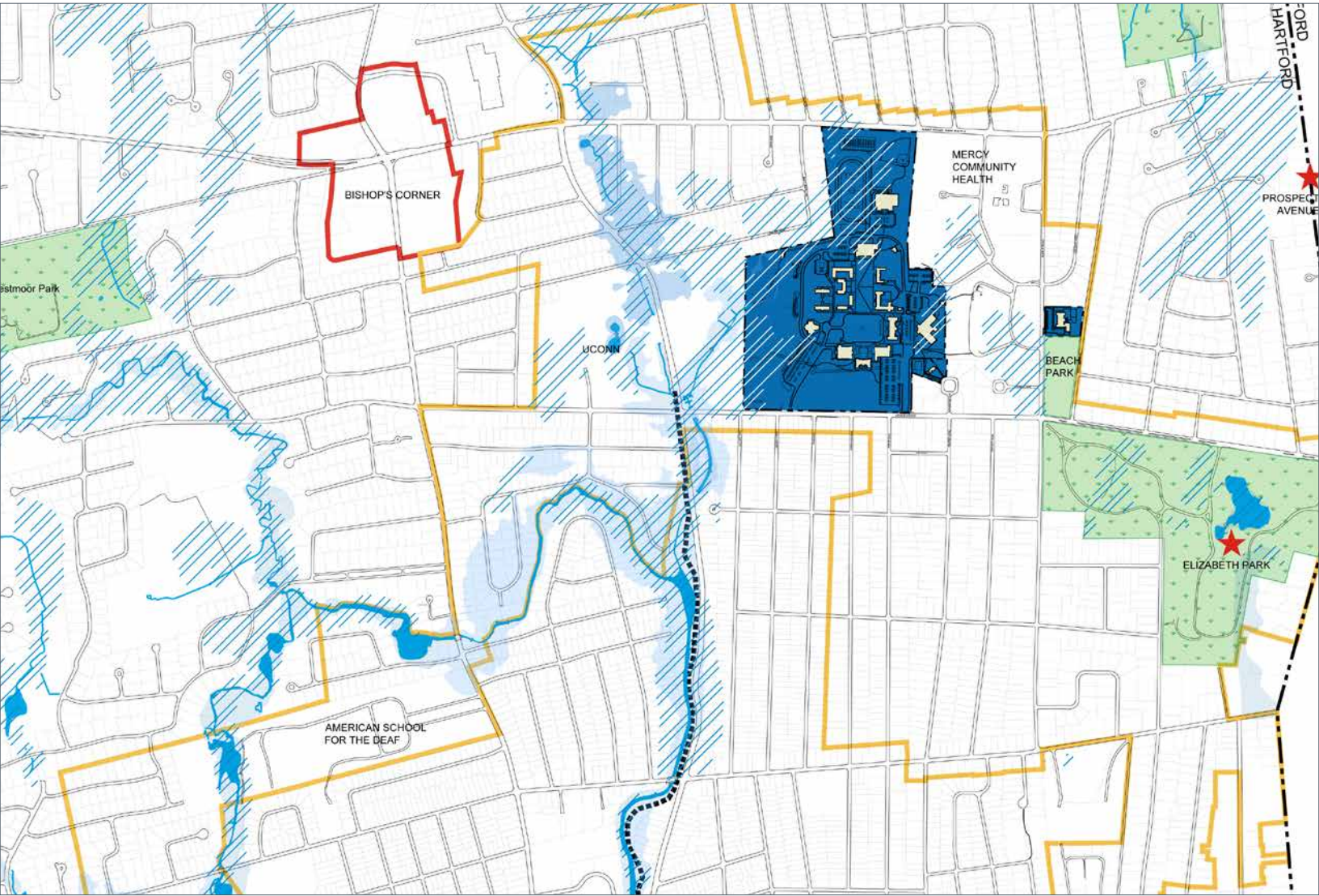

To complement and advance its mission, the College required a framework for reasoned and sustainable development of its buildings and grounds.

The plan addresses present-day challenges while anticipating potentials for the future. The campus's Olmsted quadrangles and Collegiate Georgian architecture will be preserved. Core proposals include the renovation and re-use of iconic campus buildings; the creation of a new center for allied sciences; and the relocation of grounds services. Site development proposals celebrate Saint Joseph's heritage and Catholic identity, while ensuring a learning environment appropriate to the College's focus on academic excellence and personal development.

- Founded: 1932
- Enrollment: 1,040
- No. Buildings: 20
- GSF: 462,650
- Acreage: 85

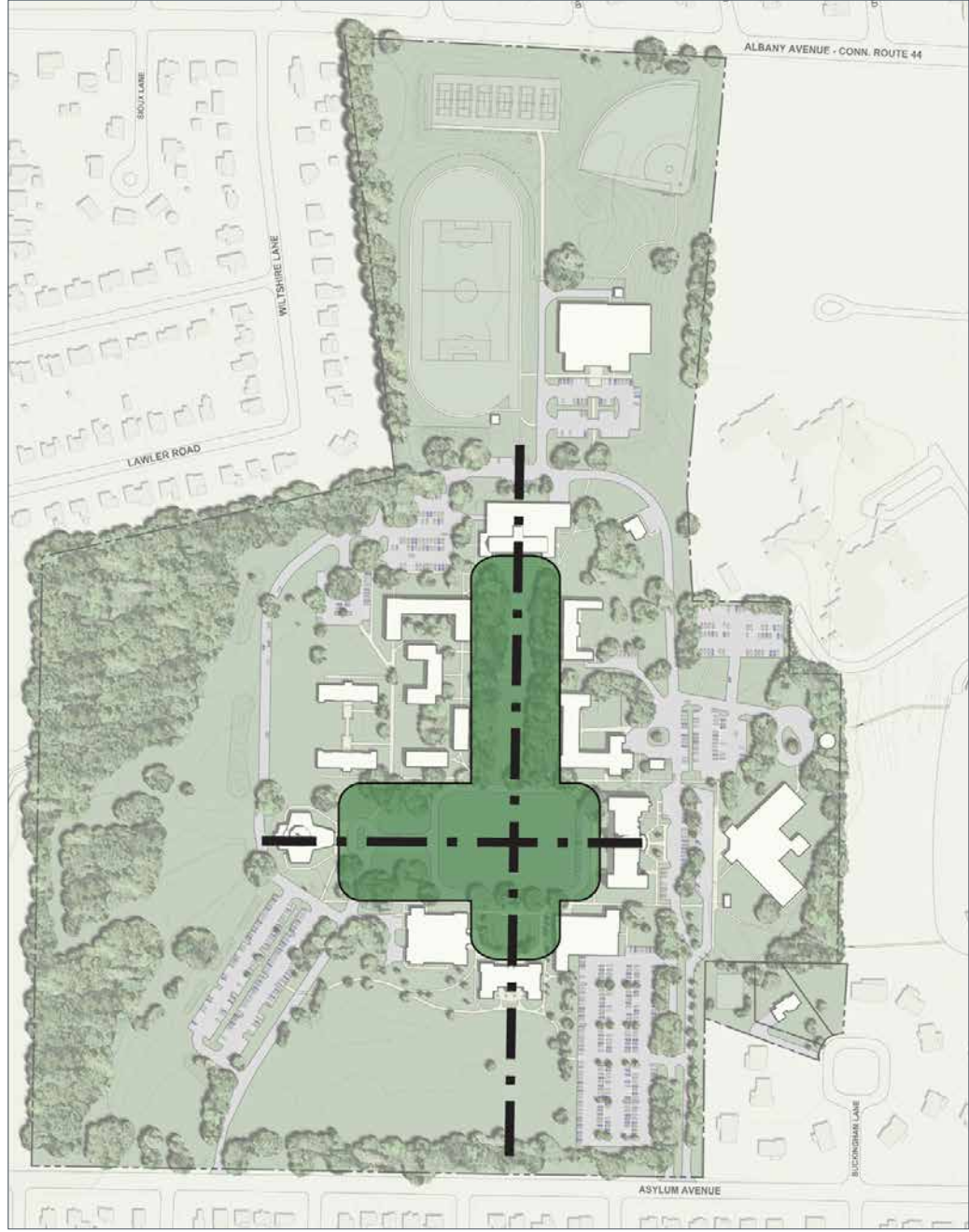

Heritage Open Space

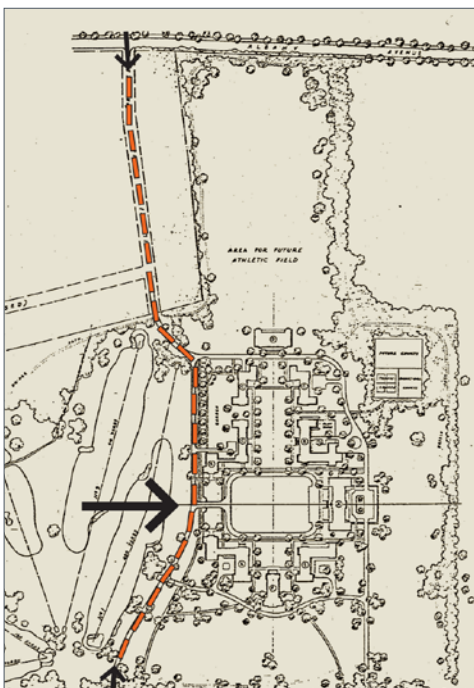

Olmsted Concept c. 1933

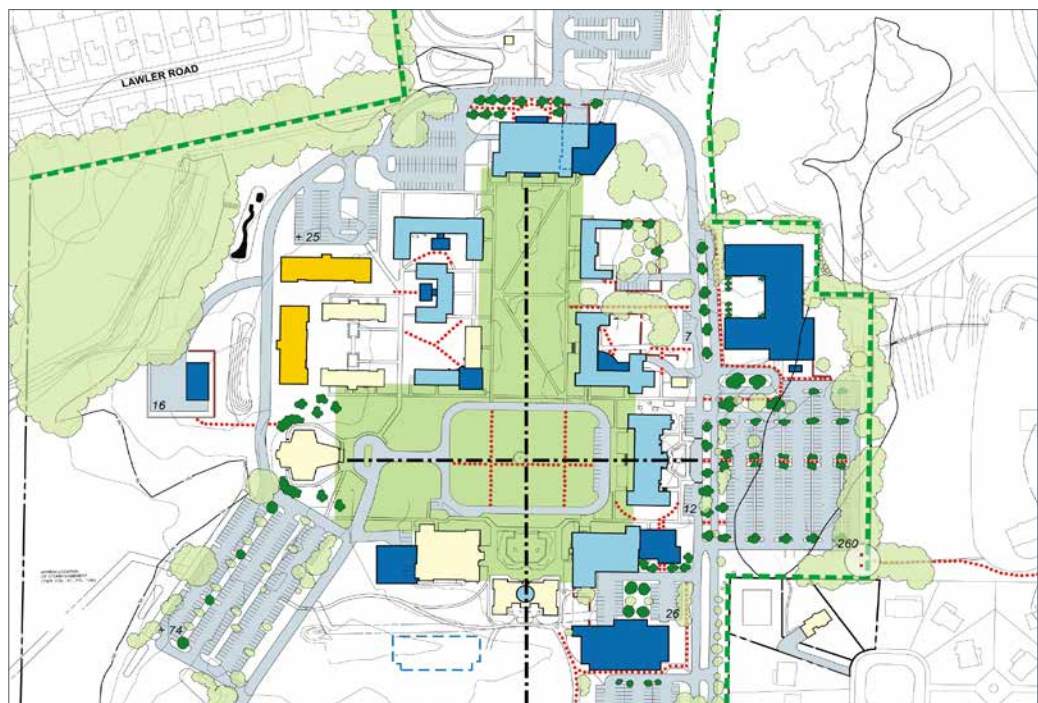

Master Plan Concept



MECCA ROAD

SHIRAS ROAD

SEQUOIA ROAD

BRAHWARD ROAD

PILGRIM ROAD

NORWOOD ROAD

COLONY ROAD

SIoux LANE

WILTSHIRE LANE

LAWLER ROAD

ALBANY AVENUE - CONN. ROUTE 44

ASYLUM AVENUE

BUCKINGHAM LANE

ALLARD DRIVE

SWOLD DRIVE

PENN DRIVE

IRELAND ROAD

BURN ROAD

BAKER LANE

OFT ROAD

Concordia College Moorhead, MN

Campus Master Plan

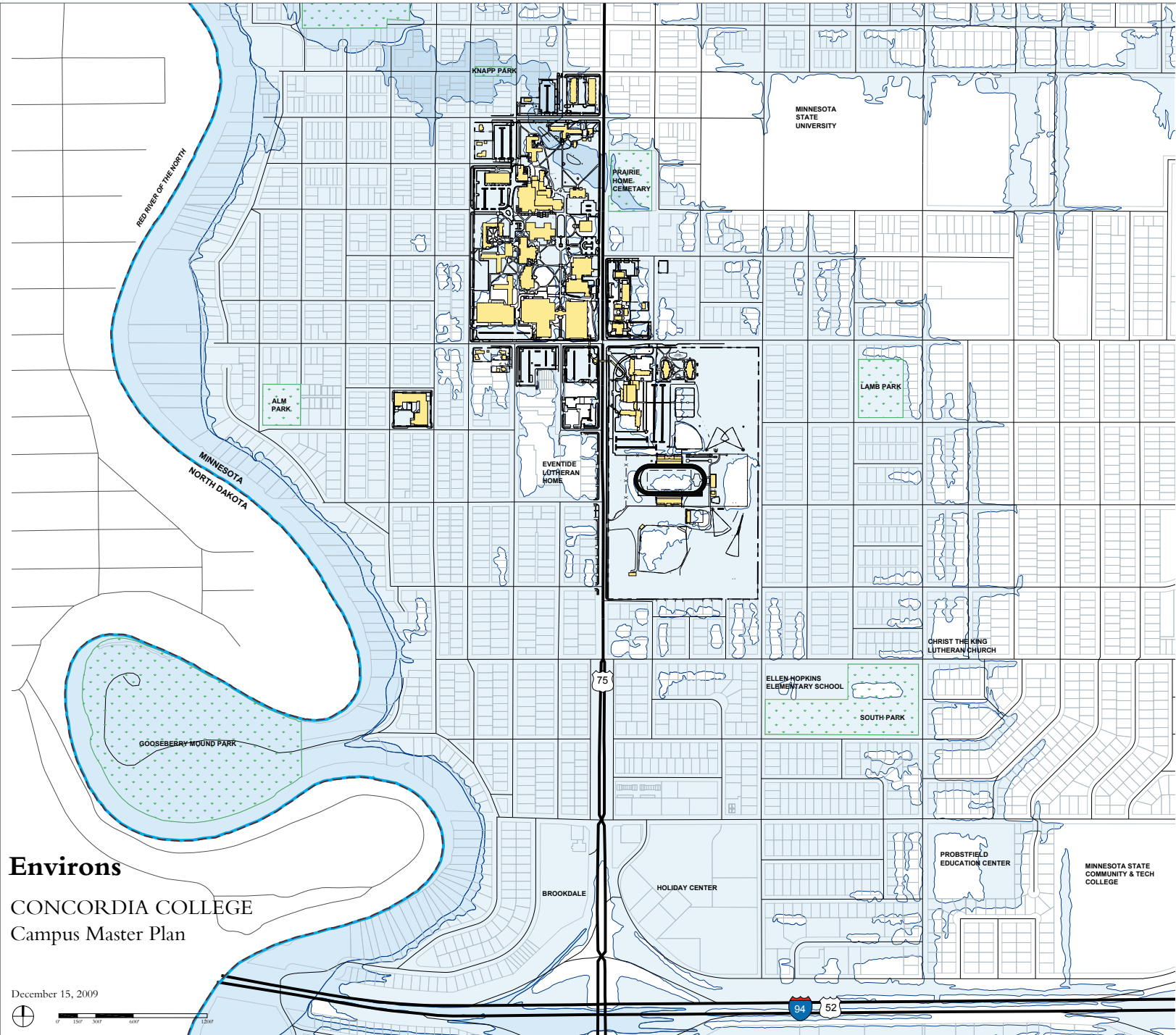

Environs
CONCORDIA COLLEGE
Campus Master Plan

December 15, 2009

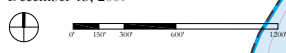

Concordia College sought to support and advance its mission and strategic initiatives by guiding near-term improvements through the next decade and setting the direction for sustainable long-term campus development.

EYP's planning process engaged campus constituents to draw upon the experiences and understanding of a wide range of participants including students, faculty, staff, administrators, and the College's Regents. A space inventory database, detailing the space available and subsequently the space needed for the future, and site analysis drawings were used to inform discussions, clarify needs, and generate proposals for alternative solutions.

The master plan advances the excellence of Concordia's programs and responds to the evolving needs of its students within a strategic framework for sustainable design and development.

- Founded: 1891
- Enrollment: 2,800
- No. Buildings: 45
- GSF: 1,448,587
- Acreage: 113



Study for New School of Business



Arrival Plaza Location



Proposed Landscape Themes



Illustrative Master Plan

CONCORDIA COLLEGE
Campus Master Plan

7 May 2010 DRAFT



Transylvania University Lexington, KY

Campus Master Plan Update

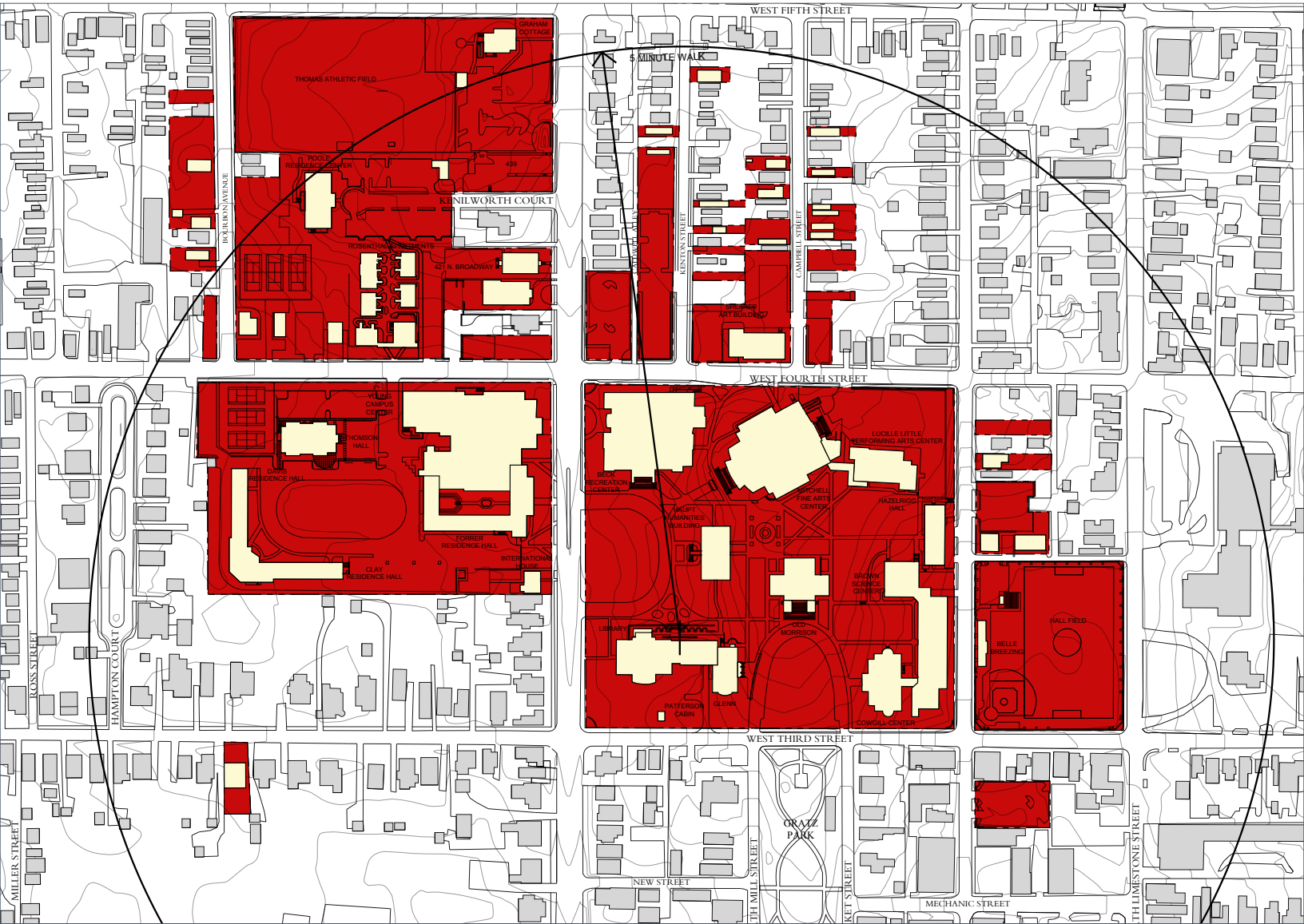

The 2010 Campus Master Plan Update for Transylvania University anticipated rising initiatives at an opportune juncture when most of the capital improvements advanced by the plan of 2002 had been realized.

The President and the executive leadership team met with the EYP team to outline the objectives of the study and confirm current conditions and oncoming challenges to be addressed. Baseline statistics were updated to reflect the evolution of conditions on campus since the prior study. Capital initiatives were identified for implementation in three general phases: Preparation – projects for immediate relief or for staging a focus project; Action – completion of a focus project; and Next Opportunity – the listing of any improvements enabled by the completion of the focus project.

The plan update complements the University's recently completed strategic plan and provides Transylvania with clear vision for near-term improvements while recommitting and elevating the University's efforts for responsible environmental stewardship.

- Founded: 1780
- Enrollment: 1,100
- No. Buildings: 35
- GSF: 821,110
- Acreage: 39 main campus

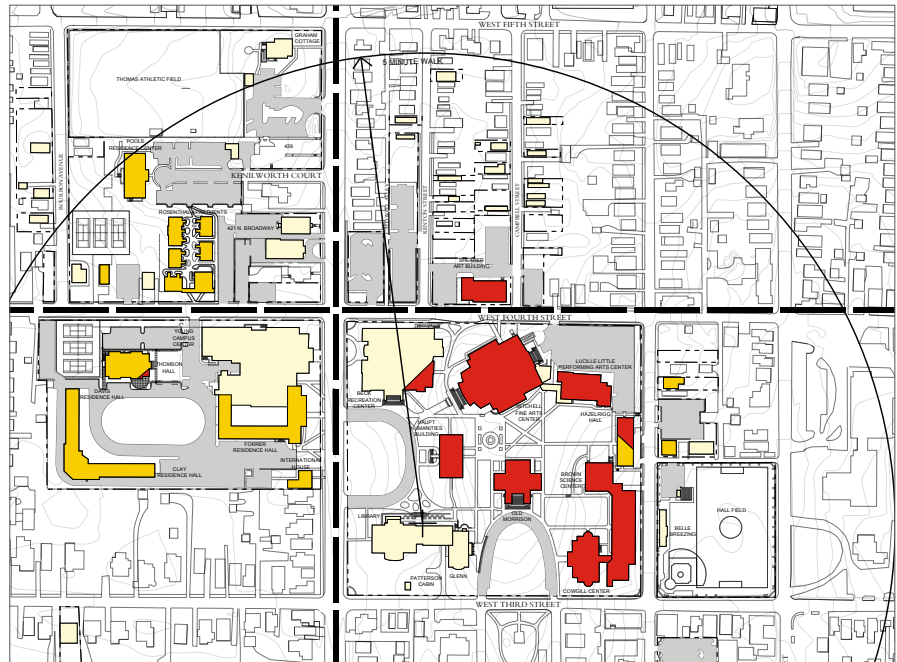
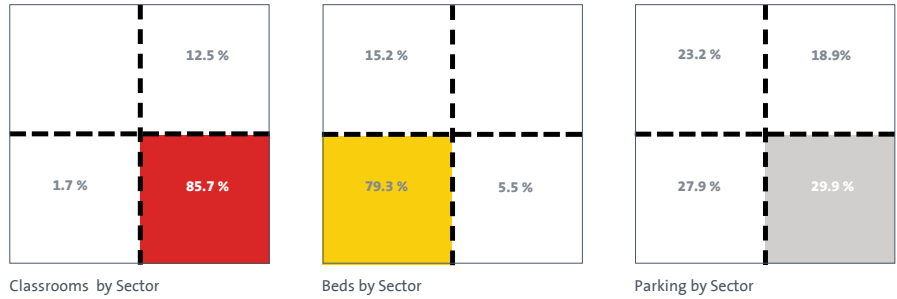

Update Analysis

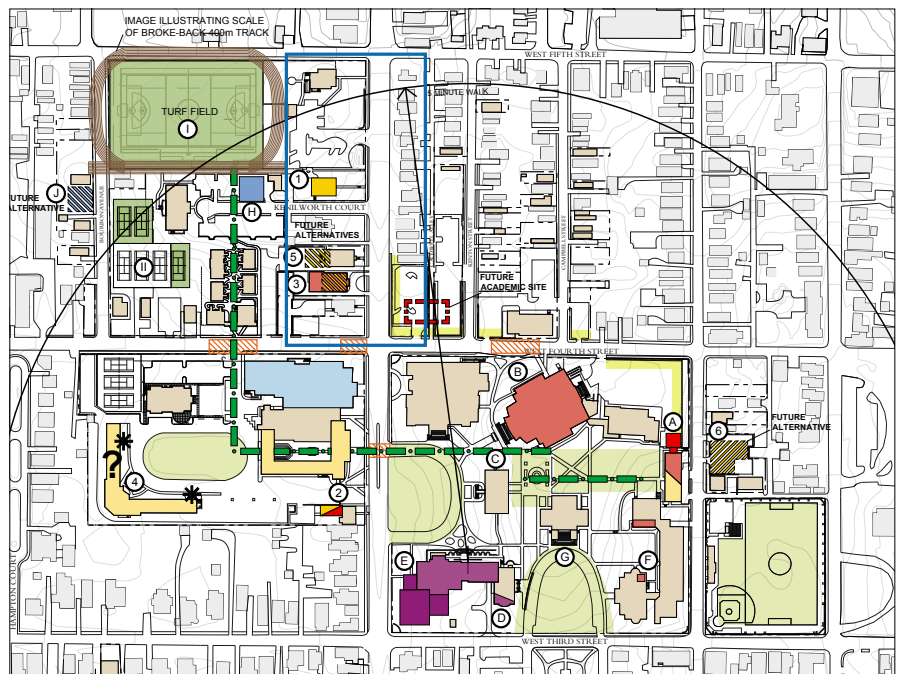

Plan Concept



Rollins College Winter Park, FL

Campus Master Plan Update



Having attained its 125th year, Rollins College positions itself as a leader in sustainability and advances liberal arts-based education in a global context. The 2011 campus master plan update focuses on a ten-year horizon of continuing development to maintain enrollments and respond to evolving program requirements. Campus buildings designed in the Mediterranean revival style are complemented by a lush tropical landscape in a lakefront setting. The human scale of the campus is a distinctive and highly valued aspect of the Rollins experience, as are the College's active integration and outreach ventures within the City of Winter Park.

EYP assisted the College in defining building requirements and identifying optimal sites for construction and landscape improvements. Planning encompassed site analyses and design studies; a building energy survey; a space inventory database; instructional space utilization analyses; collaboration with local planning agencies; and facility programming. EYP also worked with the College's Committee on Environmental and Sustainability to refine campus sustainability goals and principles.

The update plan proposals build on the unique character and heritage of the College, improve facility utilization, and integrate green strategies for development and continuing innovation. This continuum plan sustains the trajectory for the College to achieve its bicentennial potential.

- Founded: 1885
- Enrollment: 3,100
- No. Buildings: 70+
- GSF: 1,187,152
- Acreage: 79

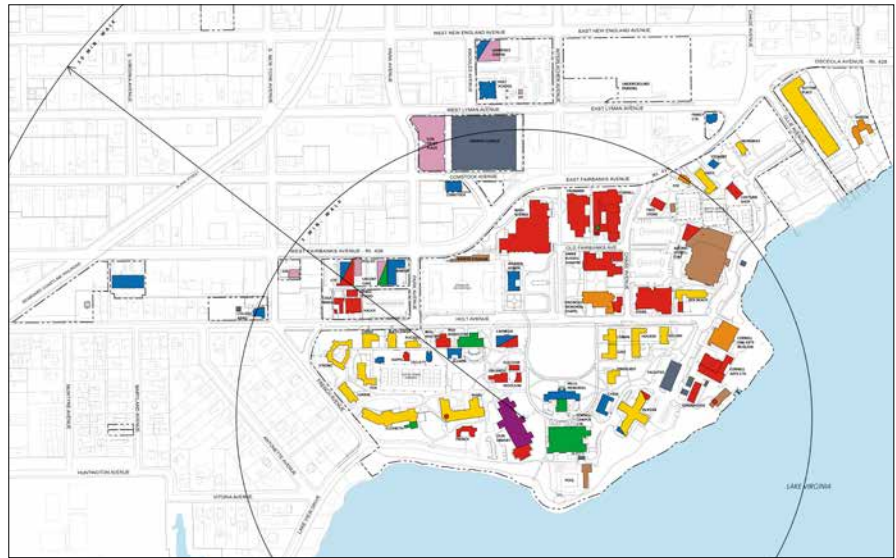

Predominant Building Use

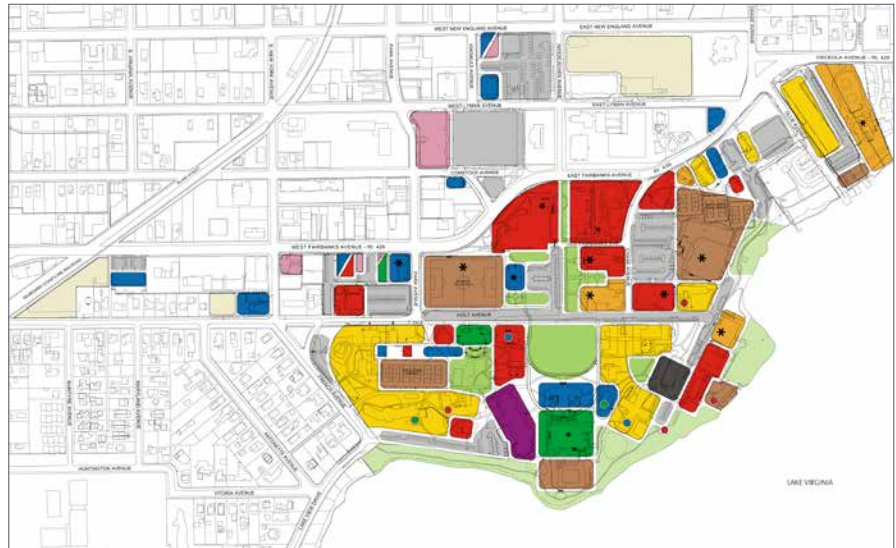

Land use



Issues and opportunities



Existing condition



Proposed Illustrative plan

FIRM OVERVIEW

Disciplines

Architecture, Engineering, Energy, Environmental Graphic Design, Interior Design, Master Planning

Integrated Design Expertise

- Academic Innovation
- Diplomatic Facilities
- Energy & Sustainability
- Health Education
- Healthcare
- Historic Preservation
- Libraries
- Master Planning
- Mission Critical Facilities
- Modernization
- Science & Technology
- STEM
- Student Life
- Workplace

Research

- Building Science
- Healthcare Design
- STEM
- Energy
- Living-Learning
- Workplace

Recognition

- 2018 Top 25 Architecture Firms, *Architectural Record*
- 2018 Giants 300, Architecture/Engineering Firms, *Building Design + Construction*
- 2018 Top 500 Design Firms, *Engineering News-Record*
- 2018 Healthcare Giants, *Interior Design*
- 2017 Architect 50, *Architect Magazine*
- 2017 MEP Giants, *Consulting-Specifying Engineer*
- 2017 Top Architects, #1 for Healthcare Renovation, *Health Facilities Construction Quarterly*

SERVICES

Architecture

- Design
- Planning
- Programming
- Interior Design
- Life Safety
- Environmental Graphic Design
- Workplace Strategy & Design
- Master Planning

Energy

- Energy Data Analysis
 - Energy modeling
 - Benchmarking
- DSM Programs for Utilities
- Building Performance Optimization
 - Energy Audits
 - Energy Master Plans
 - Retro-commissioning

Software

- B3 Benchmarking
- NEO Net Energy Optimizer®
- Custom tools with WeidtSim®

Engineering

- Electrical
- Fire Protection
- Mechanical
- Plumbing
- Security
- Structural
- Telecommunications

Consulting

- Graphic Design
- Marketing Communications
- Public Relations

HIGHER EDUCATION CLIENTS

Abilene Christian University
Adelphi University
Alamo Colleges
Albany College of Pharmacy and Health Sciences
Albany Law School
Amarillo College
American University
Amherst College
Angelo State University
Appalachian State University
Assumption College
Austin College
Austin Community College District
Austin Peay State University
Barnard College
Bay Path College
Baylor College of Medicine
Baylor University
Bemidji State University
Bennington College
Berea College
Binghamton University
Black Hills State University
Boston College
Boston University
Bowie State University
Brandeis University
Bridgewater College
Brookdale Community College
Brookhaven College
Brown University
Bryant University
Bucknell University
Buena Vista University
Cabrini College
Canisius College
Carleton College
Case Western Reserve University
Cazenovia College
Central College
Central Texas College
Chatham University
Christopher Newport University
Clarendon College
Clemson University
Clinton Community College
Coastal Bend College
Colby College
Colgate University
College of Saint Elizabeth
College of Staten Island
College of the Holy Cross
Collin College
Columbia University
Concordia College
Connecticut College
Cornell University
Dallas County Community College District
Dartmouth College
Del Mar College
Dominican College
Duke University
East Carolina University
East Carolina University School of Dental Medicine
Eastern Michigan University
Eastfield College
Effat University
El Centro College
Emmanuel College
Emory and Henry College
Emory University
Farmingdale State College, State University of New York
Finger Lakes Community College
Florida Southern College
Fordham University
Franklin & Marshall College
Franklin College
Frederick Community College
Gallaudet University
Galveston College
George Mason University
Georgetown University
Georgia Institute of Technology
Goucher College
Grinnell College
Hamilton College
Hampden-Sydney College
Hardin-Simmons University
Hartwick College
Harvard Business School

Harvard College Library
Harvard University
Harvard University, John F. Kennedy
 School of Government
Haverford College
Herkimer County Community College
Houston Baptist University
Houston Community College
Howard University
Hudson Valley Community College
Iowa State University
James Madison University
Johns Hopkins University
Kean University
Keene State College
Lafayette College
Laguardia Community College
Lamar Institute of Technology
Lamar State College - Port Arthur
Lamar University
Lehigh University
Lone Star College System
Loyola University New Orleans
Lubbock Christian University
Manhattanville College
Marist College
Marshall University
Massachusetts College of Liberal Arts
Massachusetts Institute of Technology
Massachusetts Maritime Academy
McMurry University
Medical University of South Carolina
Mercy College
Meredith College
Michigan State University
Middlebury College
Midwestern State University
Minnesota State Colleges & Universities
MIT Department of Facilities
Mitchell Community College
Mohawk Valley Community College
Monmouth University
Montclair State University
Montgomery College
Moravian College
Morgan State University
Mount Aloysius College
Mount Holyoke College
Mount Saint Mary College
Muskingum University
Navarro College
New Jersey City University
New Jersey Institute of Technology
New York University
North Carolina A&T State University
North Carolina Central University
North Carolina State University
Northern Virginia Community College
Northland College
Northwestern University
Orange County Community College
Pace University
Pennsylvania State University
Prairie View A&M University
Princeton University
Purchase College
Quinsigamond Community College
Radford University
Ramapo College of New Jersey
Rensselaer Polytechnic Institute
Rice University
Richard Stockton College of New Jersey
Rochester Institute of Technology
Rockefeller University
Rockhurst University
Rockland Community College
Roger Williams University
Rollins College
Rowan College at Burlington County
Rutgers, The State University of New Jersey
Sage Colleges
Saint Joseph's College
Sam Houston State University
San Jacinto College
Sarah Lawrence College
School of Visual Arts
Schreiner University
Siena College
Skidmore College
Southern Methodist University

HIGHER EDUCATION CLIENTS

Southwestern University
Spring Hill College
Springfield Technical Community College
St. Edward's University
St. John's University
St. Mary's College of Maryland
St. Mary's University
St. Olaf College
Stanford University
State University of New York at New Paltz
State University of New York at Oneonta
State University of New York College at Cortland
State University of New York Institute of
Technology at Utica/Rome
Stephen F. Austin State University
Stetson University
Stevenson University
Stony Brook University
Sul Ross State University
SUNY Broome Community College
SUNY Cobleskill
SUNY Geneseo
SUNY Maritime College
SUNY Polytechnic Institute
SUNY Upstate Medical University
Swarthmore College
Syracuse University
Tarleton State University
Tarrant County College
Temple University
Texas A&M College of Medicine
Texas A&M International University
Texas A&M University
Texas A&M University Baylor College of Dentistry
Texas A&M University-Central Texas
Texas A&M University-Commerce
Texas A&M University-Corpus Christi
Texas A&M University-Galveston
Texas A&M University-Kingsville
Texas A&M University-San Antonio
Texas A&M University-Texarkana
Texas Christian University
Texas Southern University
Texas State Technical College-Harlingen
Texas State Technical College-Waco
Texas State University
Texas Tech University
Texas Tech University Health Science Center
Texas Wesleyan University
Texas Woman's University
The Catholic University of America
The City University of New York
The College of New Jersey
The College of New Rochelle
The College of Saint Rose
The College of William & Mary
The College of Wooster
The George Washington University
The Ohio State University
The State University of New York
The Texas A&M University System
The Texas State University System
The University of North Carolina at Charlotte
The University of Texas at Arlington
The University of Texas at Austin
The University of Texas at Brownsville
The University of Texas at Dallas
The University of Texas at El Paso
The University of Texas at San Antonio
The University of Texas at Tyler
The University of Texas Health Science Center at Houston
The University of Texas Health Science Center at
San Antonio
The University of Texas Medical Branch at Galveston
The University of Texas of the Permian Basin
The University of Texas System
The University of Texas-Pan American
Towson University
Transylvania University
Trinity College
Trinity University
Trinity Valley Community College
Trinity Washington University
Truman State University
Tufts University
Union College
United World College
University at Albany
University at Buffalo
University of Akron

University of California
University of Charleston
University of Dallas
University of Dayton
University of Delaware
University of Denver
University of Florida
University of Houston
University of Houston - Clear Lake
University of Houston - Downtown
University of Houston - Victoria
University of Iowa
University of Mary Hardin - Baylor
University of Mary Washington
University of Maryland, Baltimore
University of Massachusetts Amherst
University of Massachusetts Dartmouth
University of Michigan
University of Minnesota
University of Missouri
University of New England
University of New Hampshire
University of New Haven
University of North Carolina at Chapel Hill
University of North Carolina at Greensboro
University of North Carolina at Pembroke
University of North Carolina at Wilmington
University of North Carolina School of Medicine
University of North Texas
University of North Texas System
University of Oxford
University of Pennsylvania
University of Pittsburgh
University of Richmond
University of Scranton
University of Southern Maine
University of St. Joseph Connecticut
University of St. Thomas
University of Tennessee at Knoxville
University of Texas MD Anderson Cancer Center
University of Texas Southwestern
Medical Center
University of the Incarnate Word
University of Vermont
University of Virginia

University of Virginia Foundation
University of Wisconsin - Madison
University System of New Hampshire
UNT Health Science Center
University of Wisconsin - Whitewater
Vassar College
Virginia Commonwealth University
Virginia Community College System
Virginia Polytechnic Institute & State University
Virginia State University
Wake Technical Community College
Washington & Jefferson College
Washington College
Washington University in St. Louis
Wayne State University
Weatherford College
Wellesley College
West Texas A&M University
West Virginia University
Western Technical College
Wharton County Junior College
Wheaton College
Williams College
Winston-Salem State University
Worcester Polytechnic Institute
Yale University
Yale University School of Medicine
Yeshiva University

EYP/

eypae.com
people, purpose, planet

© 2019 EYP Inc. All rights reserved.